

# Recessed Sanitizer / Soap Dispenser Station

installation + maintenance

+  
THE  
SPLASH  
LAB

# contents

|            |   |
|------------|---|
| 3          | Safety and warnings                     |
| 4          | Box contents                            |
| 5          | Technical data                          |
| 6          | Before you install                      |
| 7          | How to install the unit and refill soap |
| 12         | Operation                               |
| 12         | Maintenance                             |
| 13         | Cleaning                                |
| 14         | Troubleshooting                         |
| 15         | Diagram                                 |
| 16         | Warranty                                |
| Back Cover | Contact details                         |

# Recessed Sanitizer / Soap Dispenser Station

Read and save these instructions

**WARNING** 

To reduce the risk of fire, electric shock or injury to persons, observe the following:

- + Use this unit only in the manner intended by the manufacturer. If you have any questions, contact the manufacturer.
- + This equipment should be installed in a way that ensures all electrical parts are kept dry.
- + A means of electrical isolation must be incorporated in the fixed wiring, in accordance with the current local regulations in force.
- + Disconnect the power supply before performing any maintenance on the product.
- + Children should not play with this equipment. Cleaning and maintenance shall not be performed by children without supervision.
- + This equipment is designed to be used in commercial and public areas; it is not intended for domestic or residential use.
- + Ensure wiring and cover is installed correctly before connecting to live power supply.
- + If in doubt, consult an electrician.

## General information

(310) 410-5008

Showroom:

8745 Washington Boulevard, Studio D, Culver City CA 90232

Warehouse + Offices:

20809 Higgins Court, Torrance CA 90501

## Technical support

[info.usa@thesplashlab.com](mailto:info.usa@thesplashlab.com)

**For further contact information visit:**

[www.thesplashlab.com/usa](http://www.thesplashlab.com/usa)

# box contents

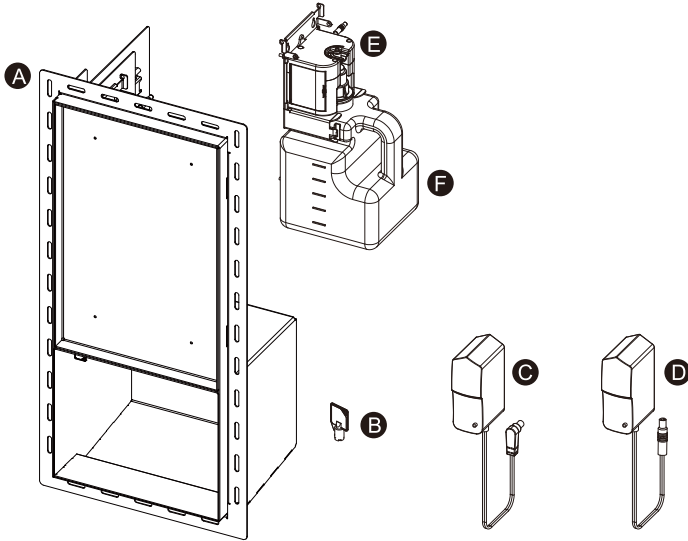

A Sanitizer/soap dispenser frame

---

B Key

---

C Power supply unit - LED

---

D Power supply unit -  
dispensing mechanism

---

E Control box

---

F Soap reservoir - 0.8 gallons

---

# technical data

|                               |  |                   |
|-------------------------------|--|-------------------|
| Finishes                      | Recessed Sanitizer /<br>Soap Dispenser Station           | Brushed stainless |
| Power supply - soap dispenser | Input 100-240V ac; 50/60Hz<br>Output 6V DC, 1.5A, 9W max |                   |
| Power supply -LED             | 100-240V ac; 50/60Hz<br>Output: 12V DC; 1.0A             |                   |
| Standby power                 | 9mA (Soap dispenser) / 100mA (LED)                       |                   |
| Weight                        | 27lb 8oz   |                   |
| Material                      | 304 stainless steel                                      |                   |
| Sensor range                  | 2-3/4"±9/16" (nonadjustable)                             |                   |
| Recommended viscosity         | Suitable for alcohol gels sanitizers                     |                   |
| Approvals                     | CE, RoHS   |                   |
| Warranty                      | One year limited warranty                                |                   |

# before you install

## Power supply

Two power outlets must be provided for connection to the mains power supply.

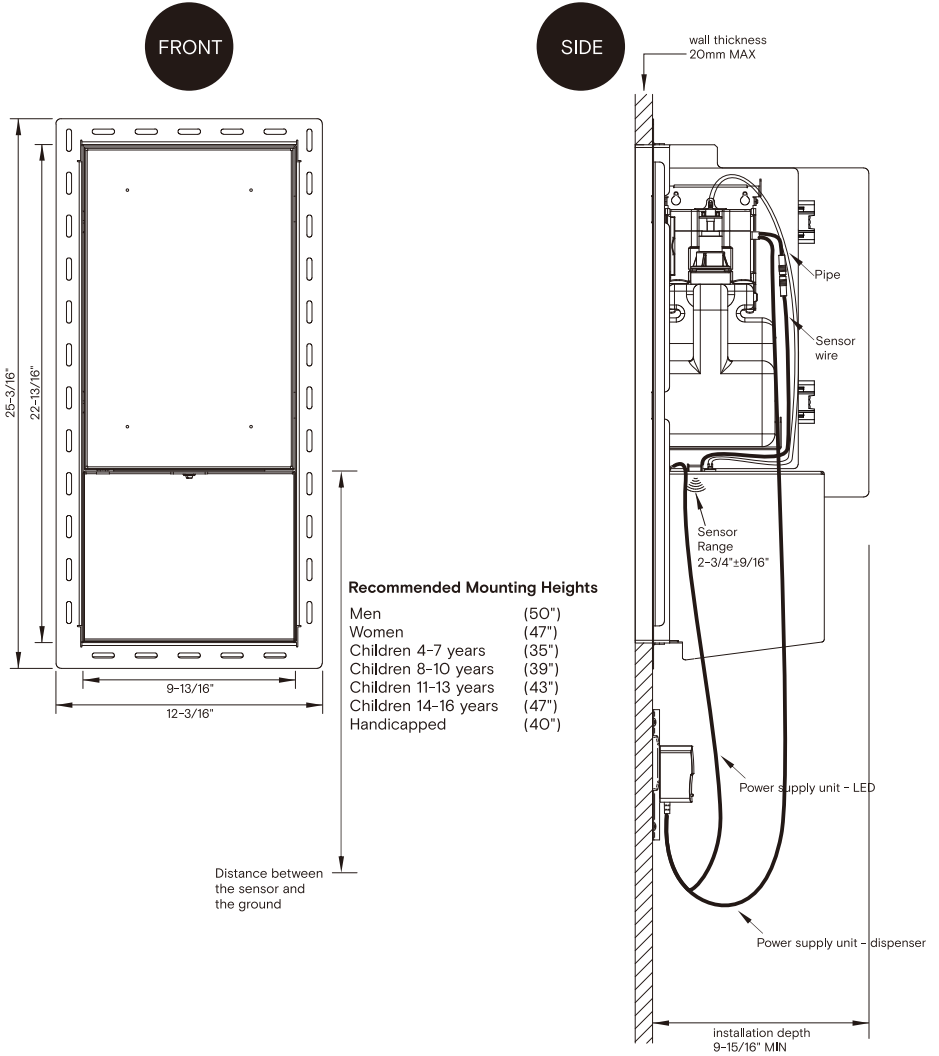

# how to install the unit and refill soap

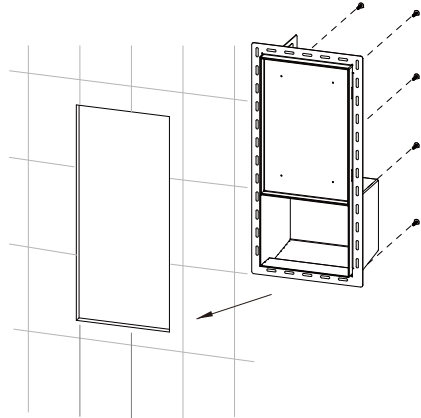
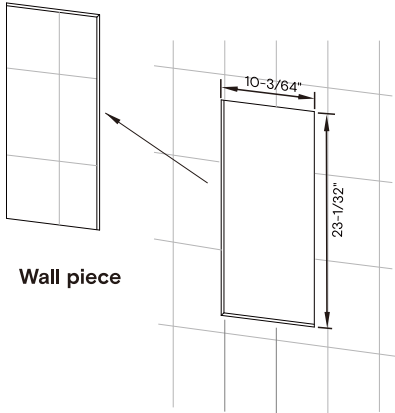

## 1

Cut out a rectangular piece of the wall for installing the station.

Dimensions:

10-3/64" (W) x 23-1/32" (H) x 25/32" (D)

\* Retain the cut out wall piece.

## 2

Insert the station from the back of the wall into the rectangular hole, fix the unit to the wall with 10 screws.

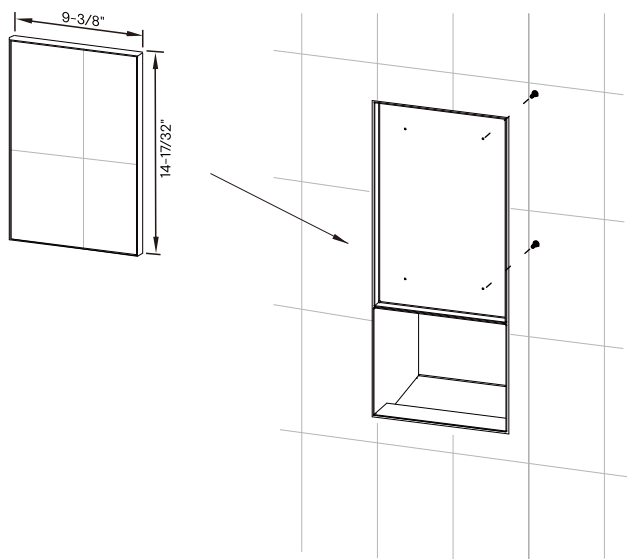

### 3

Cut the wall piece from step 1 to 9-3/8" (W) x 14-17/32" (H) x 25/35" (D).  
Insert the wall piece into the unit and fix it to the front plate from the back of the wall with 2 screws.



# how to install the unit and refill soap

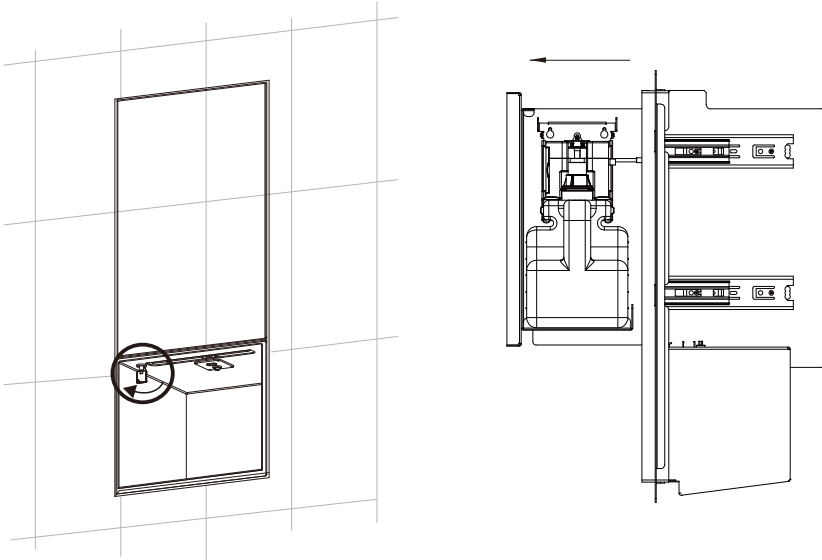

## 4

Insert the key from the tool kit into the keyhole and rotate counterclockwise. This will release the module from the wall so the tank can be easily accessed for refilling. Put the soap tank off from the station module from the side of the unit to refill soap and place it back into the station module to complete the process. Ensure the soap pump is properly reinserted into the soap tank.

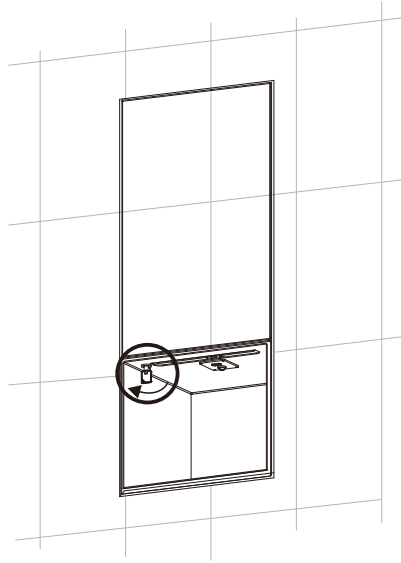
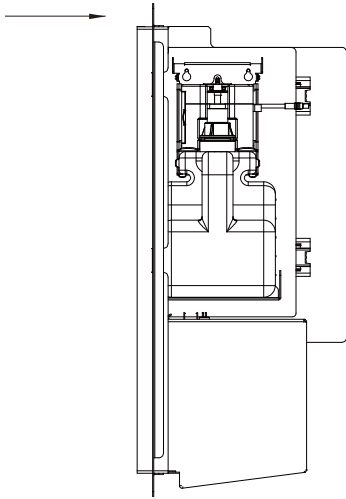

## 5

After filling soap, push on the wall piece to reinsert the station module back into the unit. Insert the key into the keyhole and turn clockwise to lock the wall piece and the station module in place.

# how to install the unit and refill soap

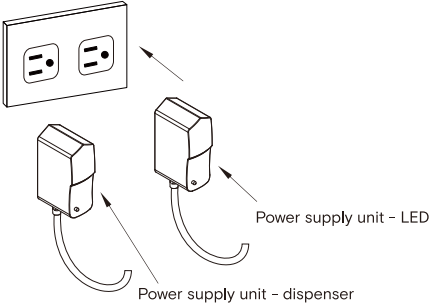
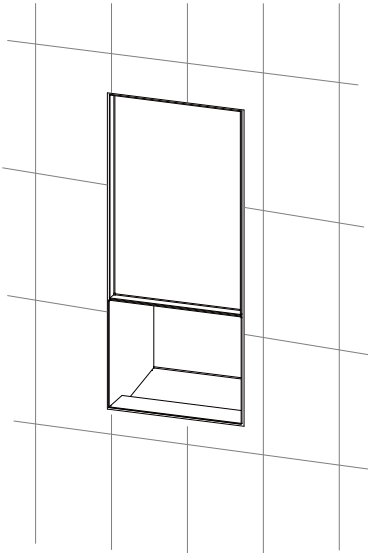

## 6

Connect the station and the LED light strip to power. Verify that the dispenser and LED light strip are functioning and that the installation is complete.

# operation

- + The user is to place hands under the sensor to activate the recessed sanitizer / soap dispenser station.  
The user then places hands within the detection range of the sensor to activate the recessed sanitizer / soap dispenser station.
- + The motor will start and soap is dispensed onto the user's hands.

# maintenance

- + The recessed sanitizer / soap dispenser station should be serviced on a regular basis to ensure long service life of the unit.
- + Isolate the unit from the power supply before any servicing or maintenance work is carried out.
- + The recessed sanitizer / soap dispenser station should be activated at least once a day to ensure that soap does not congeal in the pipework.

# cleaning

- + All grades of stainless steel will stain or discolor if due care and attention is not taken. The surface must be regularly cleaned to ensure a long service life of the recessed sanitizer / soap dispenser station.
- + Use a soft cloth or sponge with a mild solution of soapy water as part of the regular washroom janitorial routine. Do not use abrasive or cream cleaners as these will damage the surface finish.
- + If the recessed sanitizer / soap dispenser station is subjected to a highly chlorinated environment e.g. swimming pools or marine coastal locations, a further treatment, in addition to the regular cleaning as described above, is recommended to use a household cleaning product containing silicone.
- + If further information is required, contact The Splash Lab Team for more detailed stainless steel care guidelines.

# troubleshooting

If the recessed sanitizer / soap dispenser station will not run

---

- + Ensure there is power to the station and the wire from the AC adapter is connected correctly to the pump motor.
  - + Check that the sensor cables are fully connected to the corresponding cables from the foam pump unit.
- 

If the recessed sanitizer / soap dispenser station can be heard to operate, but soap is not dispensed

---

- + Check that the soap pick-up pipe is fully immersed in the soap in the reservoir. If necessary, replenish the soap in the reservoir.
  - + Check that there are no leaks in the pipework, and that all connections are fully pushed home.
- 

If the recessed sanitizer / soap dispenser station runs all the time

---

- + It is likely that the sensor is detecting either an object or reflection causing it to operate constantly.
  - + Remove the obstruction or cause of reflection.
- 

LED does not come on

---

- + Please replace LED.
  - + If LED still does not come on after being replaced, please change the adapter.
- 

We are always looking to improve. If these steps did not solve your problem please contact us and we will endeavor to help.

Tel: (310) 410-5008

Email: [info.usa@thesplashlab.com](mailto:info.usa@thesplashlab.com)

# diagram

FRONT

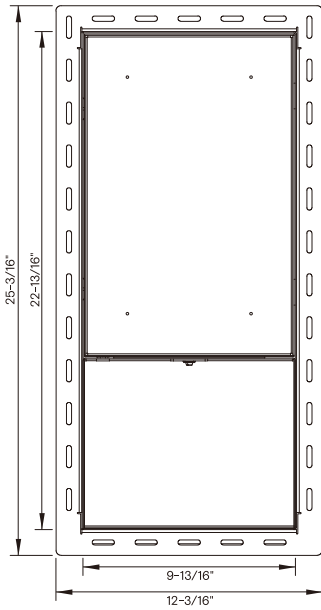

BACK

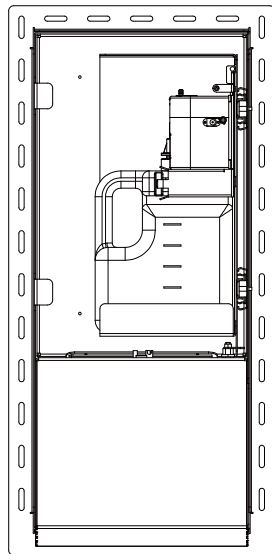

# warranty

Will be warranted by The Splash Lab to be free of manufacturing and material defects during normal use and environmental conditions as detailed below:

One year limited warranty

If a defect is found in normal use, The Splash Lab will, at their discretion, repair, provide

- + a replacement part or product, or make appropriate adjustments. Damage caused by accident, misuse, or abuse is not covered by this warranty. Improper care and cleaning will void the warranty.

Non-operation of the product due to environmental conditions beyond our control,

- + installation error, incorrect maintenance, water quality, fair wear and tear, incorrect or inappropriate installation, misuse and abuse is not covered by the warranty.

Proof of purchase (original sales receipt) must be provided to The Splash Lab with all

- + warranty claims.

The above warranty is valid for goods supplied within North America.

- + For goods supplied outside of North America, The Splash Lab will honor the above stated warranty periods for the parts only.

THE SPLASH LAB DISCLAIM ANY LIABILITY FOR SPECIAL, INCIDENTAL OR

- + CONSEQUENTIAL DAMAGES.









# contact



Recessed Sanitizer / Soap Dispenser Station • (US) • REV 0-12/09/23

## General information

(310) 410-5008

Showroom:

8745 Washington Boulevard, Studio D, Culver City CA 90232

Warehouse + Offices:

20809 Higgins Court, Torrance CA 90501

## Technical support

[info.usa@thesplashlab.com](mailto:info.usa@thesplashlab.com)

**For further contact information visit:**

[www.thesplashlab.com/usa](http://www.thesplashlab.com/usa)

