

# TSL.C051 / TSL.C052

Channel sensor tap

installation + maintenance

+  
THE  
SPLASH  
LAB

# contents

3	Warning	
4 - 5	Box contents	
6	Technical data	
7 - 10	Before you install	
11 - 13	How to install	
14 - 15	The complete system	
16 - 17	Resetting the sensor	
18	Operation + maintenance	
19	Spare parts	
20 - 21	Troubleshooting	
22	Warranty	
23	Contact us	

## Read and save these instructions

### WARNING

To reduce the risk of fire, electric shock or injury to persons, observe the following:

- + Use this unit only in the manner intended by the manufacturer. If you have questions, contact the manufacturer.
- + This equipment should be installed in a way that ensures all electrical parts are kept dry.
- + A means of electrical isolation must be incorporated in the fixed wiring, in accordance with the current local regulations in force.
- + Disconnect the power supply before performing any maintenance on the product.
- + Children should not play with this equipment. Cleaning and maintenance shall not be performed by children without supervision.
- + This equipment is designed to be used in commercial and public areas; it is not intended for domestic or residential use.
- + Ensure wiring is installed correctly before connecting to live power supply.
- + If in doubt, consult an electrician.
- + Not to be installed above such surfaces as china or chrome drain covers.

### For more information contact:

#### General information

info.uk@thesplashlab.com  
+44 (0)161 482 7000

Technical support  
info.uk@thesplashlab.com

For further information visit:  
[www.thesplashlab.com/uk](http://www.thesplashlab.com/uk)

# box contents

## Channel Sensor Tap / 230mm

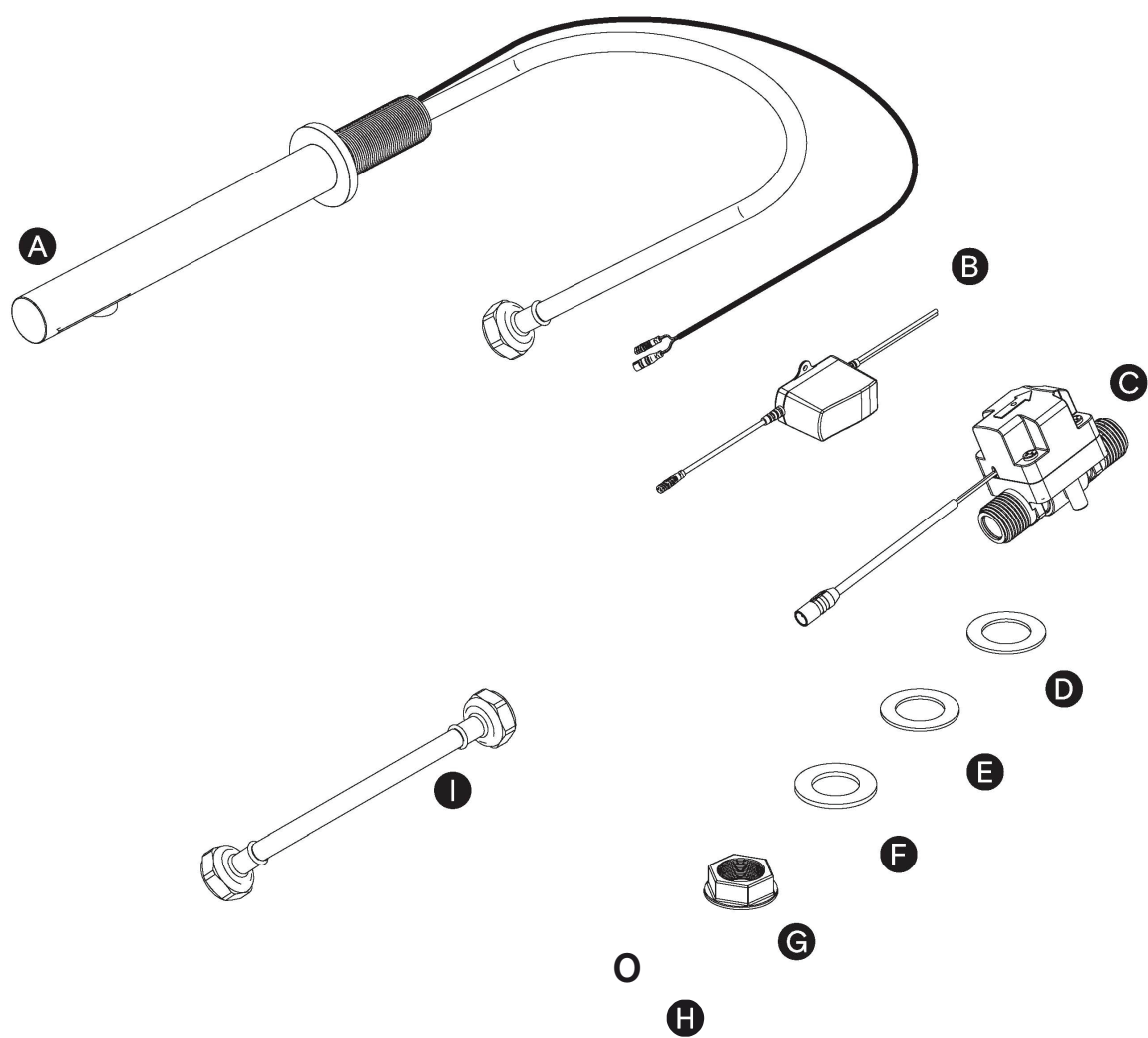

A Channel sensor tap head

B Mains power supply

C Solenoid valve

D Pad

E Gasket

F Washer

G Fixing nut

H Flow restrictor

I Flexi hose - 300mm

\* Unit ships assembled. Hardware not included.

# box contents

## Channel Sensor Tap / 170m

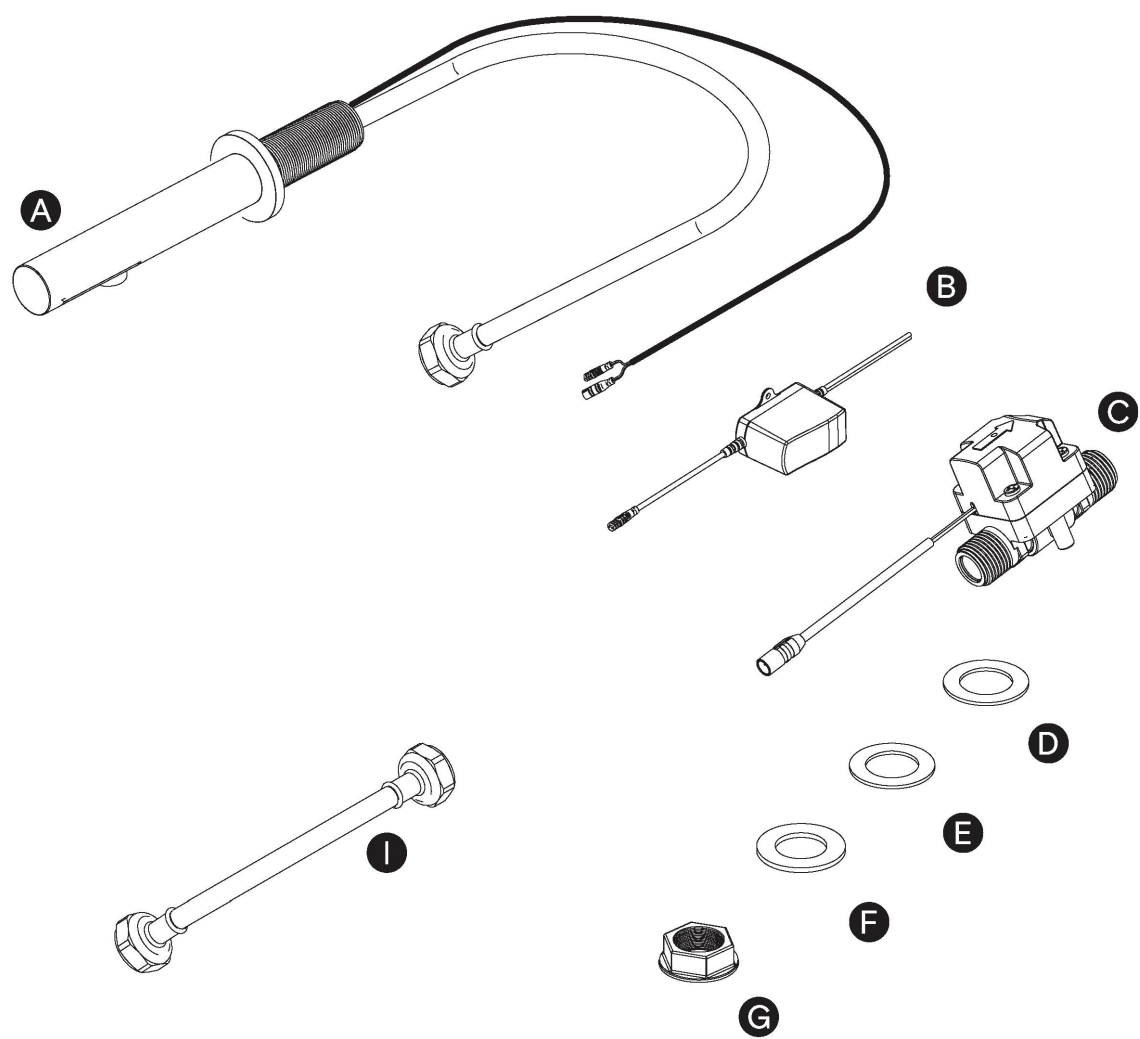

A	Channel sensor tap head	F	Washer
B	Mains power supply	G	Fixing nut
C	Solenoid valve	H	Flow restrictor
D	Pad	I	Flexi hose - 300mm
E	Gasket		

\* Unit ships assembled. Hardware not included.

# technical data

	C (Bright polished) CS (Brushed satin stainless steel) BK (Brushed black PVD) BR (Brushed brass PVD) CP (Brushed copper PVD) BZ (Brushed bronze PVD)
Finishes	
Material body	316 Stainless steel
Operating pressure	7 – 87 psi dynamic pressure
Flow rate	1.9 litres/minute – 3.8 litres/minute – 1.3 litres/minute optional
Weight	1 year limited warranty
Power supply – Mains	Input: 100-240V ac; 50/60Hz Output: 6V DC; 0.5A, 3W max
Sensor range – Preset	120±20mm
Sensor range – Minimum	50mm
Sensor range – Maximum	150mm
Comfort delay	2 seconds
Security time	60 seconds
Approvals	ASME A112.18.1, CSA B125.1, NSF/ANSI/CAN 61, WRAS, CE, UKCA, RoHS

# before you install

## TSL.C051

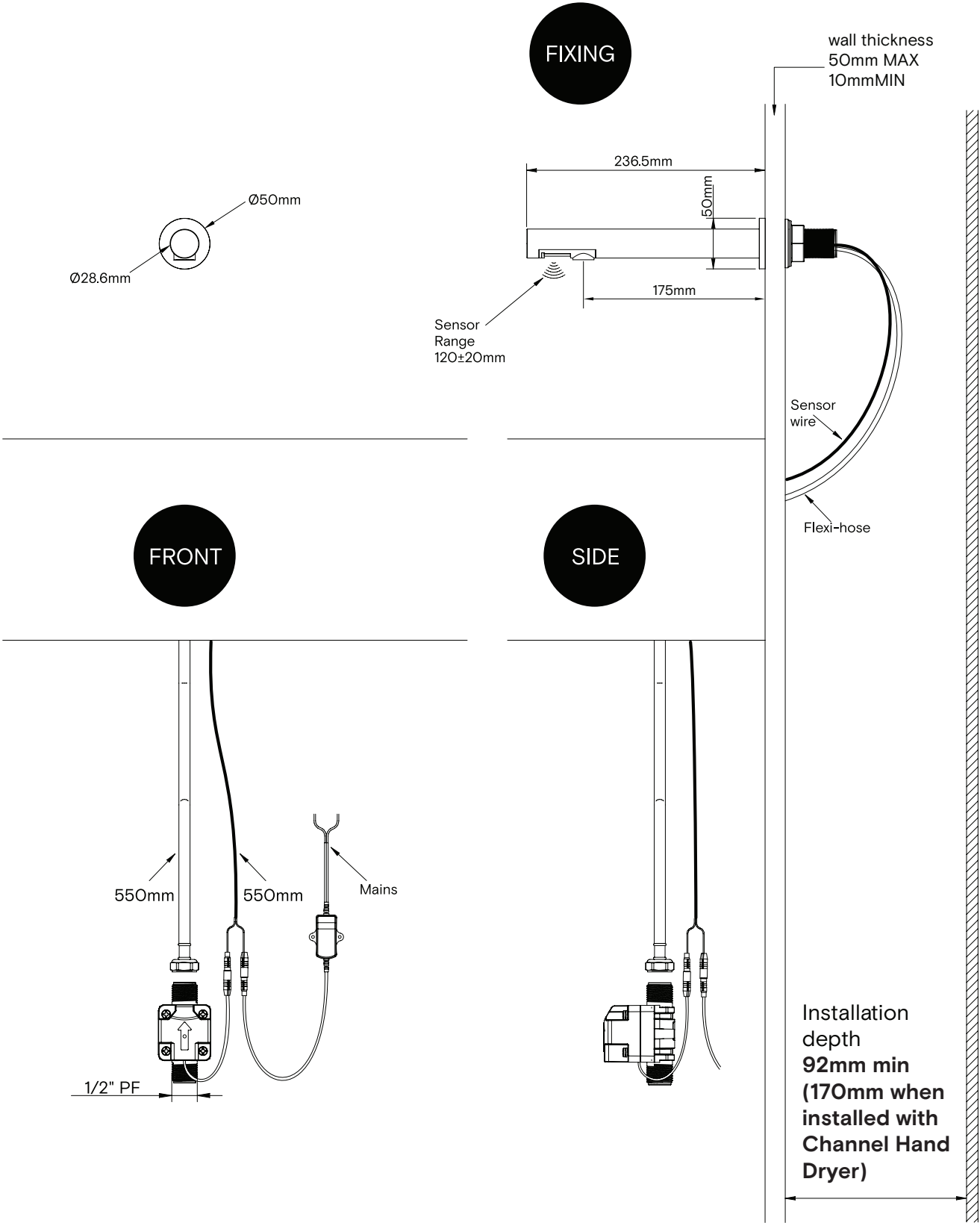

# before you install TSL.C052

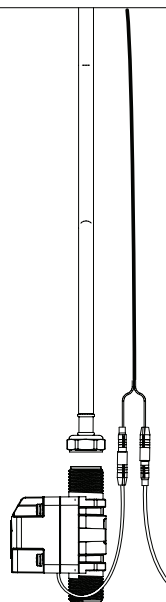
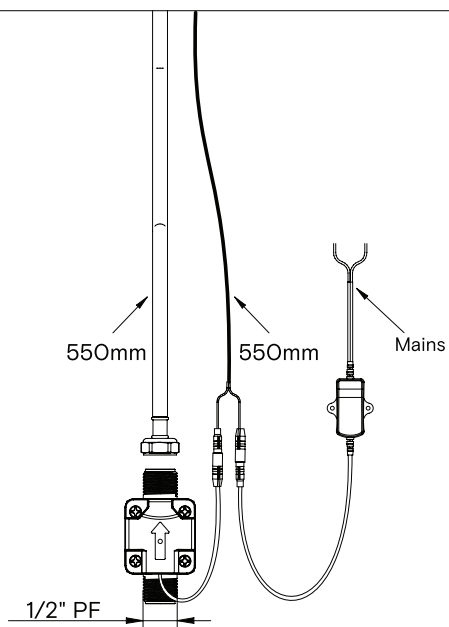
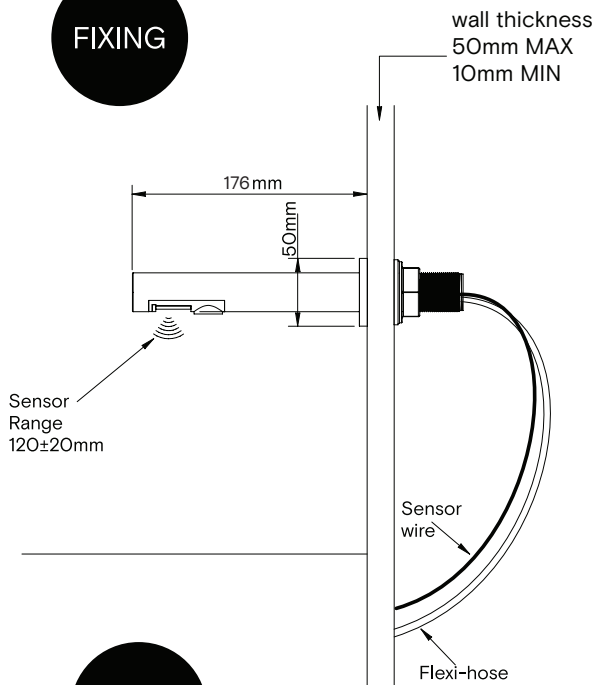
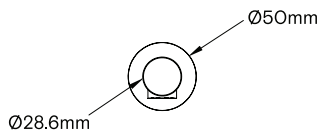

Installation  
depth  
**92mm min**  
**(170mm when**  
**installed with**  
**Channel Hand**  
**Dryer)**



# before you install

## **Flow rates**

---

Different flow rates may need to be achieved. The Splash Lab offers a number of flow regulators which can be used in conjunction with the Channel Tap. Contact The Splash Lab for more information.

## **Water temperature**

---

The Channel Tap does not come equipped with temperature control. Premixed water must therefore be supplied separately.

## **Sinks**

---

Use of a The Splash Lab monolith is recommended when used in conjunction with any of the The Splash Lab Channel fixtures.

When using other sinks, ensure that holes and appropriate mounting points are created in accordance with the diagram below.

## **Spacing**

---

If the Channel Tap is installed with other units from the Channel System, it should be installed in the center with the Soap Dispenser installed at 150mm to the left and the Hand Dryer installed at 200mm to the right.

# before you install

## Basins

The Splash Lab Monolith Basin is recommended for use with the Channel range of products. If an alternative basin is used. Please speak to a specification consultant at The Splash Lab to ensure compatibility.

## Backplate

The Splash Lab offers an optional backplate for the fixtures that means the fixtures can be mounted from the front and have simpler access.

### Front view

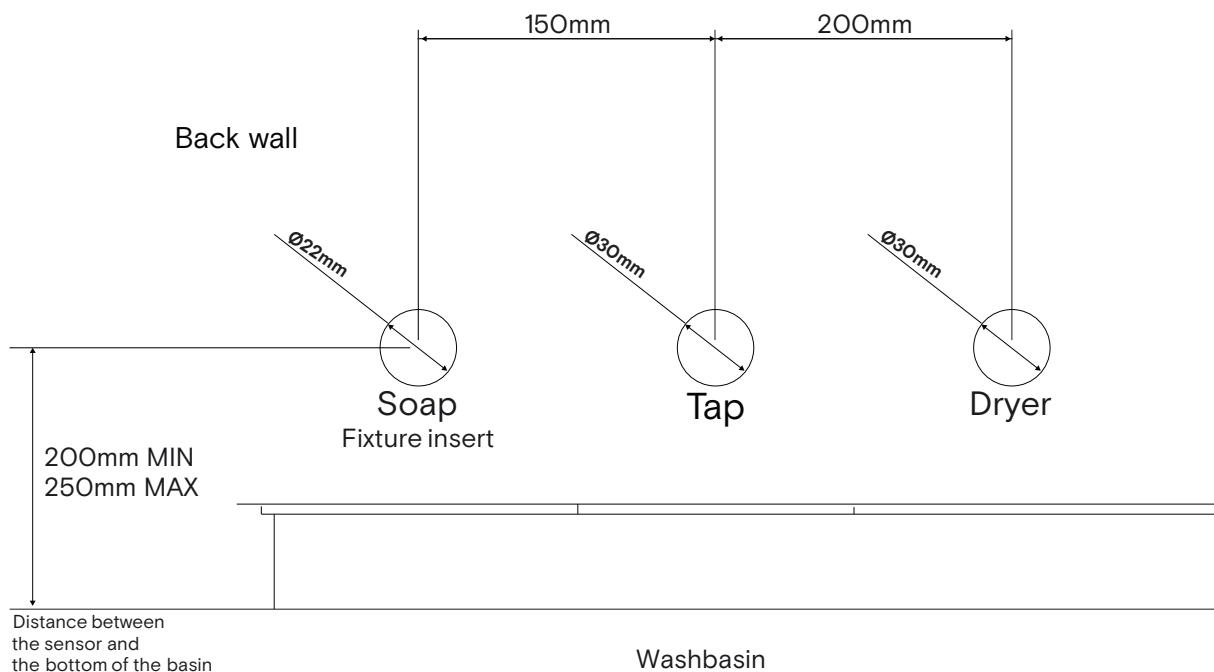

# how to install

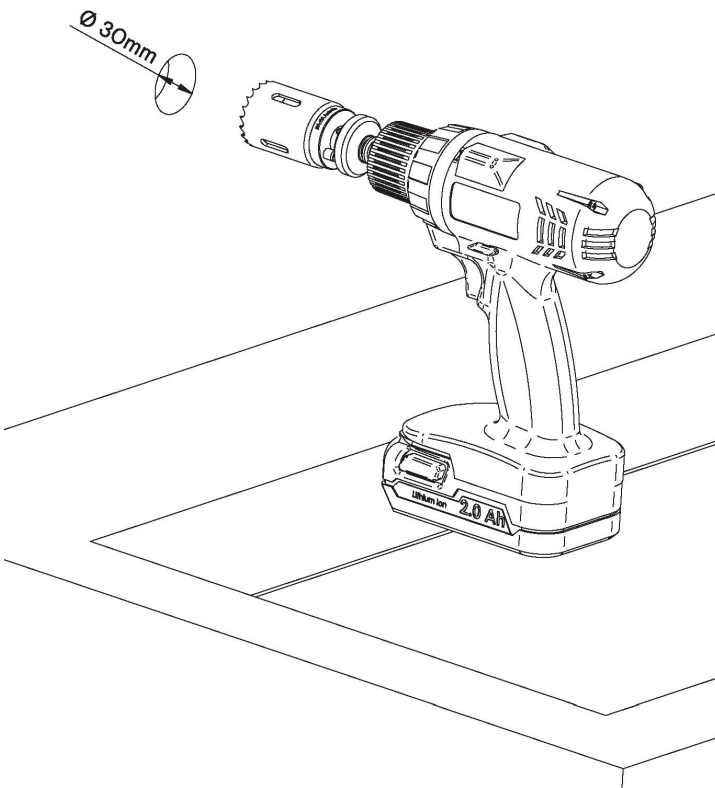

**1**

Drill hole 30mm diameter in wall 200-250mm above the bottom of the basin.

**2**

Fit tap body into the 30mm hole in wall.

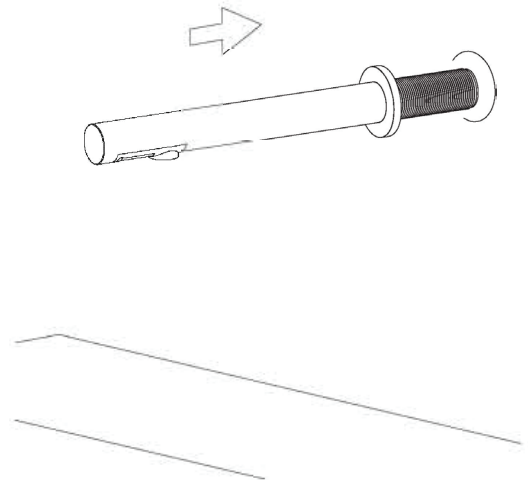

# how to install

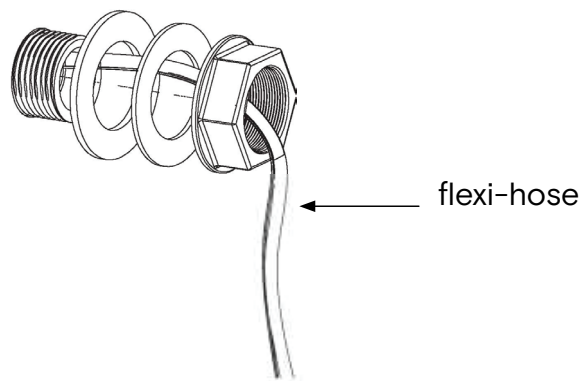

**3**

Thread the sensor wire and flexi-hose through the gasket, washer and fixing nut then tighten the nut against the installation wall.

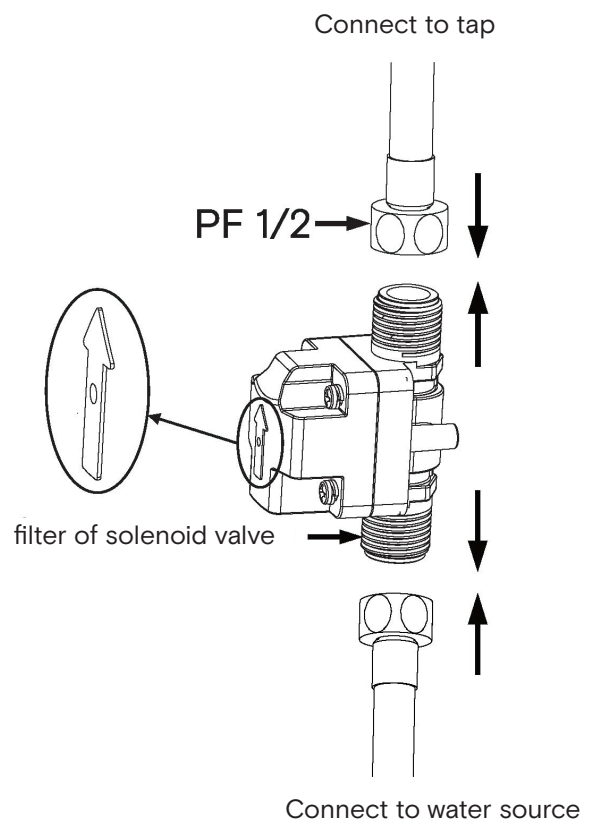

**4**

With the arrow on the side of the solenoid pointing up, as shown, fasten the water outlet hose to the top connector. Fasten the water inlet tube to the bottom connector of the solenoid valve.

# how to install

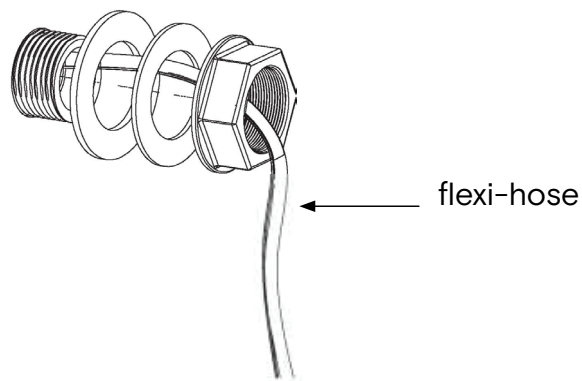

**3**

Thread the sensor wire and flexi-hose through the gasket, washer and fixing nut then tighten the nut against the installation wall.

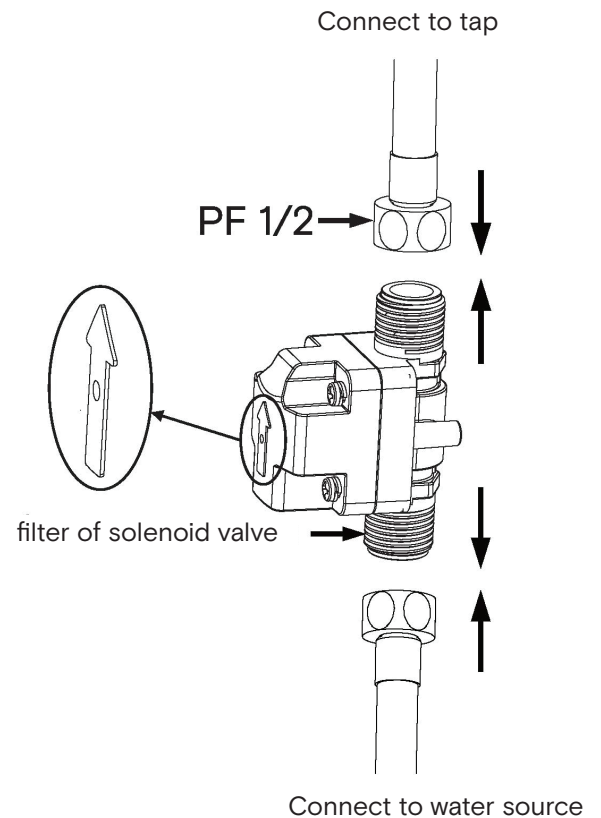

**4**

With the arrow on the side of the solenoid pointing up, as shown, fasten the water outlet hose to the top connector. Fasten the water inlet tube to the bottom connector of the solenoid valve.

# the complete system

## channel Sensor Tap / 230mm

TSL.CO51

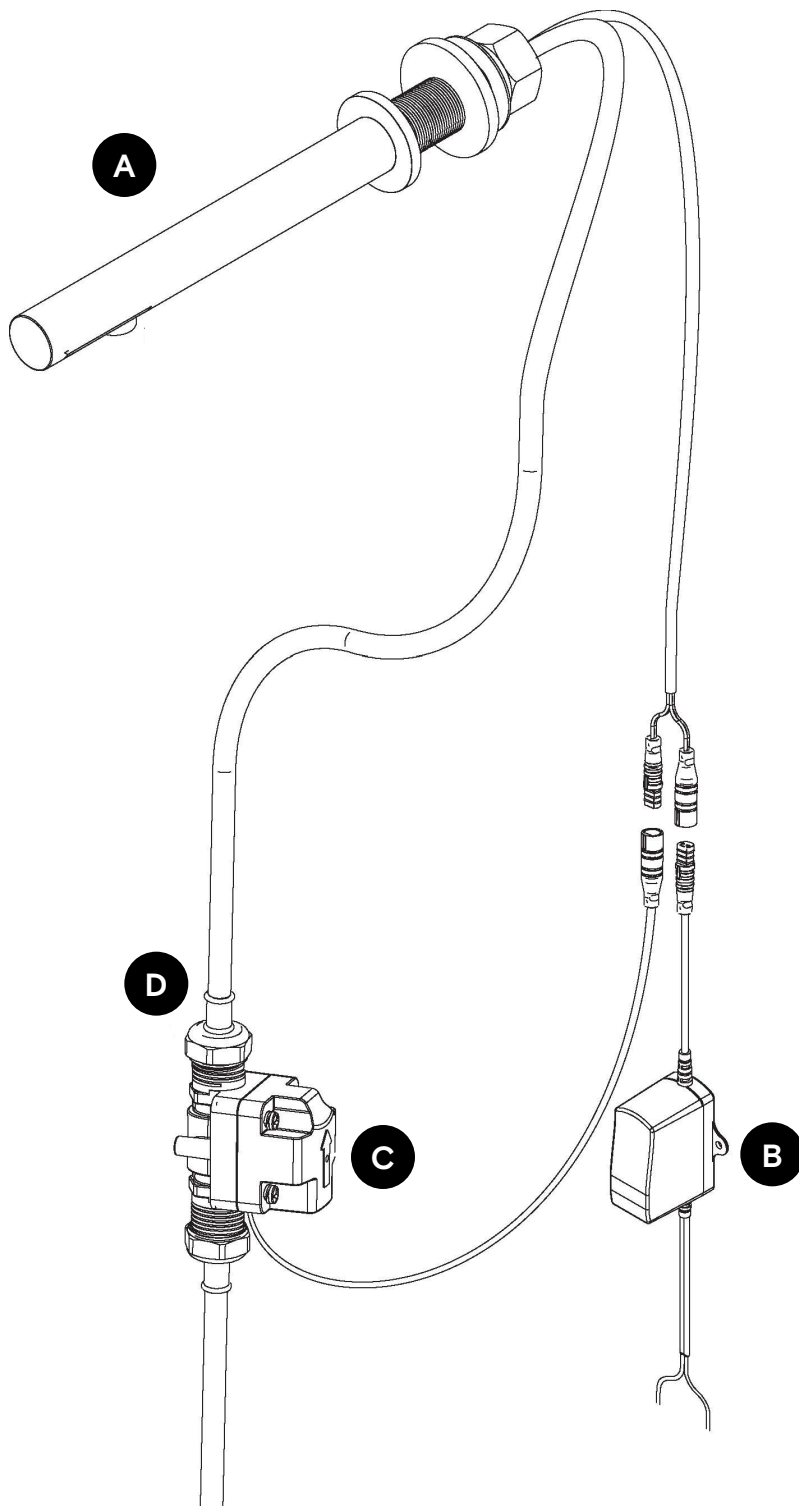

A	Channel sensor tap head
B	Mains power supply
C	Solenoid valve + cable
D	Flow restrictor

# the complete system

## channel Sensor Tap / 170mm

TSL.C052

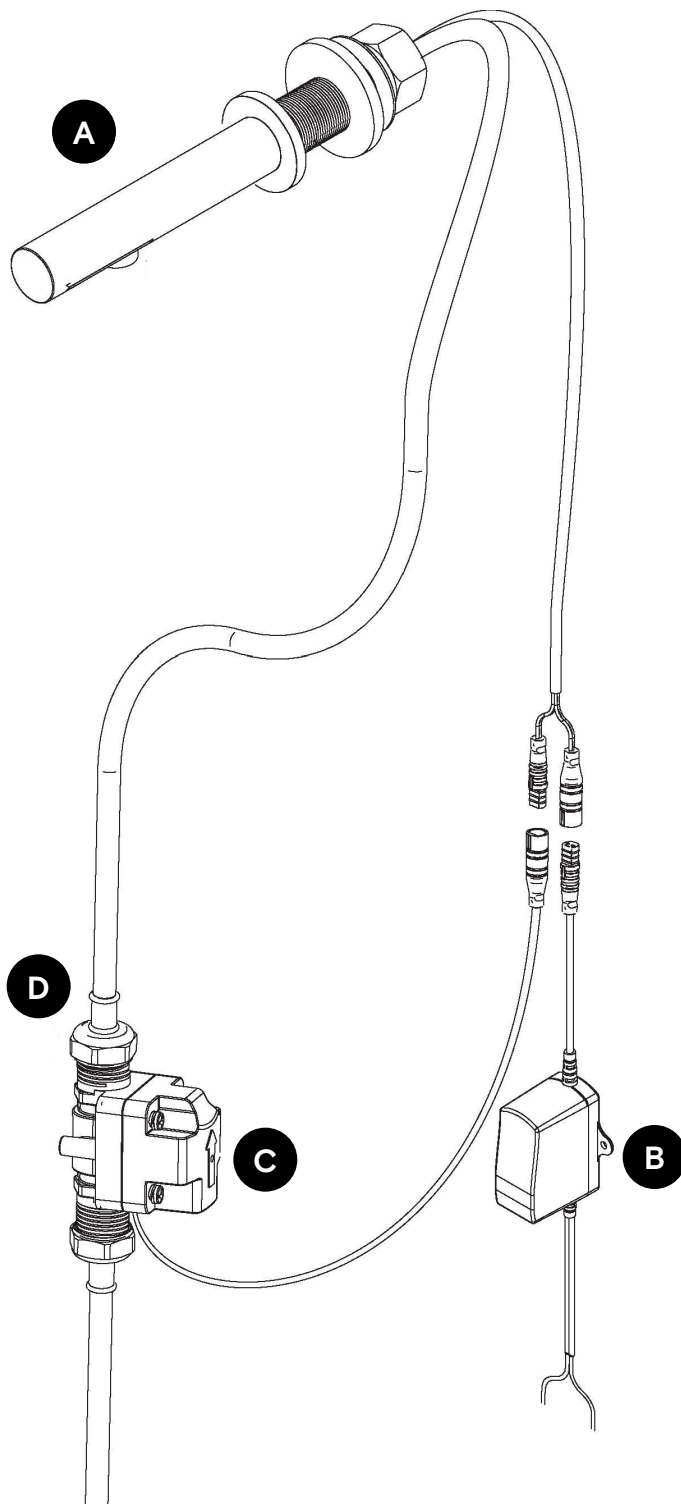

A	Channel sensor tap head
B	Mains power supply
C	Solenoid valve + cable
D	Flow restrictor

# comissioning

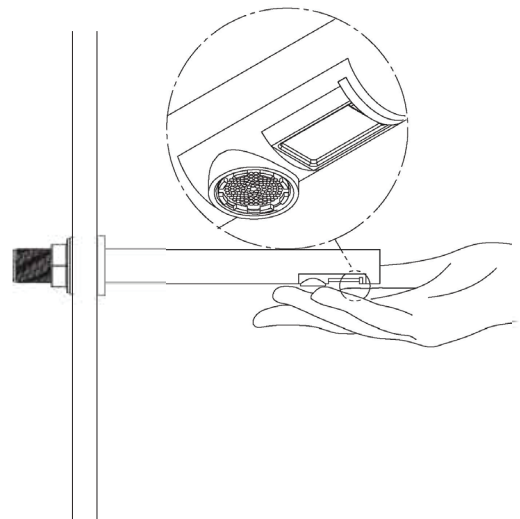
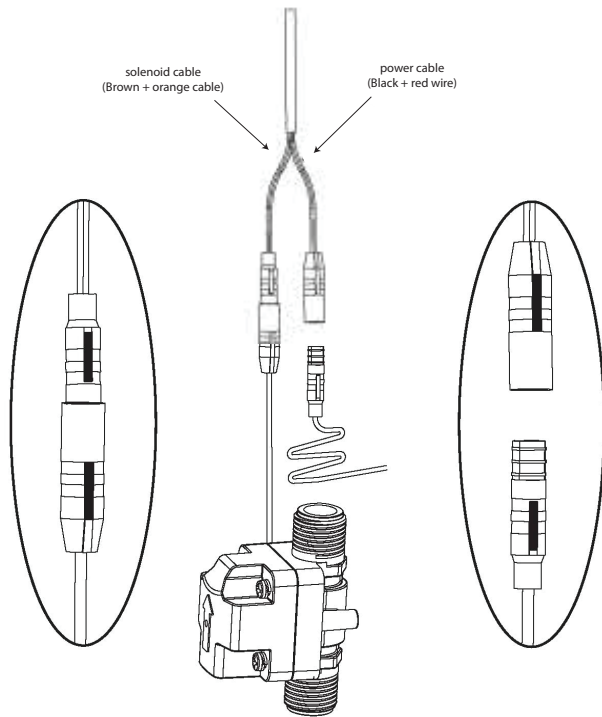

**1**

First disconnect the Channel tap head from the Power unit. Wait a minimum of 4 seconds and reconnect the power.

**2**

After connecting to power, immediately place your hand at about 50mm below the sensor on the tap head and keep it there for 3 seconds.



# comissioning

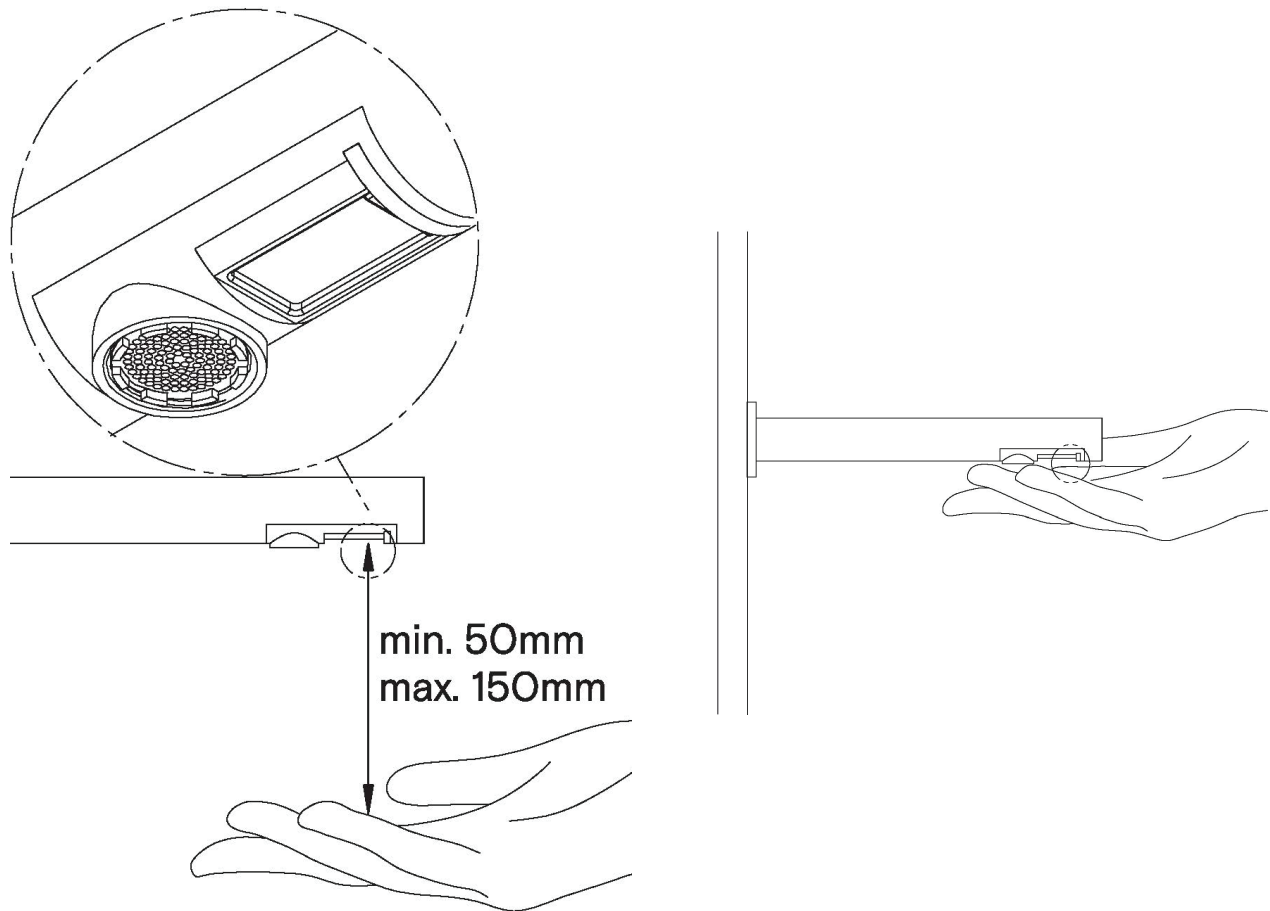

**3**

At the end of the 3 seconds, move your hand away from the sensor and down towards the wash basin to set the desired sensor range (min. 50mm, max. 150mm) and keep your hands at the desired position for 3 seconds.

**4**

At the end of 3 seconds, move your hand back to the original 50mm position from the sensor and keep at the position for 3 seconds to complete setting up the desired sensor range.

\* Remove reflective clothing during installation

# operation + maintenance

## cleaning

All grades of stainless steel will stain or discolour if due care and attention is not taken. The surface must be regularly cleaned to ensure a long service life of the dispenser.

Please use a clean cloth to wipe away the dusts and/or water mark on the spout or use a damp cloth to clean it. It is recommended to clean the spout every six months, depending on the frequency of usage and environment.

Use a soft cloth or sponge with a mild solution of soapy water as part of the regular washroom janitorial routine. Do not use abrasive or cream cleaners as these will damage the surface finish.

If the tap is subjected to a highly chlorinated environment eg swimming pools or marine coastal locations, a further treatment, in addition to the regular cleaning as described above, is recommended by the application of a household cleaning product containing silicone.

Please cut off the power, turn off the water inlet and remove the valve. Clean the filter on the valve with a soft brush. It is recommended to clean the valve every six months, depending on the frequency of usage and environment.

If further information is required, contact The Splash Lab technical team for more detailed stainless steel care guidelines.

# product identification

A unique product identification code can be found on the product tag attached to the water hose.

## access information

### **Access requirements**

---

It is critical all components which require fixing behind the wall are easily accessible at all times during installation and routine maintenance

# troubleshooting

## **Water does not flow/ cannot hear valve open**

---

- + There is no power to valve or sensor
- + Check that cables are connected
- + Check that transformer is operating and supplying 6 volts
- + Sensor range is incorrect
- + Adjust sensor setting (see pages 14 – 17)

## **Water does not flow / valve can be heard to open**

---

- + Water supply is blocked to valve
- + Check and clean filter on solenoid valve
- + Check water supply for any blockages or restrictions
- + Water pressure is too low
- + Check pressure of water supply

## **Water does not flow / sensor light is flashing all the time**

---

- + Supply voltage has dropped below 5.4V
- + Check power supply and if necessary replace the power wire

# troubleshooting

## **Water runs nonstop**

---

- + Ensure the protrusions on each solenoid cable connector aligns with each other.  
If the solenoid cables are not connected properly, nonstop water flow may occur.  
Please see page 11 for instructions.
- + Ensure the solenoid valve is installed with the side arrow pointing up.  
See page 11 for instructions.
- + Remove any obstruction below the sensor.

## **Water flow rate reduced:**

---

- + Clean the solenoid valve filter.

## **For more information contact:**

### **General information**

info.uk@thesplashlab.com  
+44 (0)161 482 7000

Technical support  
info.uk@thesplashlab.com

For further information visit:  
[www.thesplashlab.com/uk](http://www.thesplashlab.com/uk)

# warranty

We believe the future is personal. With a global mindset, we challenge conventional restroom norms via product innovation to create considered washroom solutions for corporate and educational spaces. We use rich raw materials, cutting-edge automation and considered washroom design to powerfully and positively influence the lives of people. We are The Splash Lab.

Demonstrating our commitment to quality and our belief in the strength of our designs, we can offer the following warranties.

The Splash Lab will warrant that its products will be free of manufacturing and material defects during normal use and environmental conditions as detailed below:

**TSL.CO51 Channel Sensor Tap 230mm**  
**TSL.CO52 Channel Sensor Tap 170mm**

**2 year limited warranty**  
**2 year limited warranty**

If a defect is found in normal use, The Splash Lab will, at their discretion, repair, provide a replacement part or product, or make appropriate adjustments. Damage caused by accident, misuse, or abuse is not covered by this warranty. Improper care and cleaning will void the warranty. Non-operation of the product due to environmental conditions beyond our control, installation error, incorrect maintenance, water quality, fair wear and tear, incorrect or inappropriate installation, misuse and abuse is not covered by the warranty.

Proof of purchase (original sales receipt) must be provided to The Splash Lab with all warranty claims. The above warranty is valid for goods supplied within the United Kingdom.

For goods supplied outside of the United Kingdom, The Splash Lab will honor the above stated warranty periods for the parts only.

**THE SPLASH LAB DISCLAIMS ANY LIABILITY FOR SPECIAL, INCIDENTAL OR CONSEQUENTIAL DAMAGES.**

# contact



## General information

[info.uk@thesplashlab.com](mailto:info.uk@thesplashlab.com)

+44 (0)161 482 7000

The Splash Lab

Unit 8, Acorn Business Park

Heaton Lane

Stockport

Cheshire

SK4 1AS

Technical support

[info.uk@thesplashlab.com](mailto:info.uk@thesplashlab.com)

For further information visit:

[www.thesplashlab.com/uk](http://www.thesplashlab.com/uk)

