

# Floor Mounted Doorstop

TSL.H30

A minimalistic, floor-mounted doorstop in a brushed satin finish and sheathed in a durable, soft rubber to protect the door and doorstop body. Made from high grade stainless steel. Also available in four PVD colourised finishes.

Finish	Codes	LRV*
● Satin	TSL.H30.CS	58
● Black	TSL.H30.BK	3
● Brass	TSL.H30.BR	40
● Copper	TSL.H30.CP	19
● Bronze	TSL.H30.BZ	17

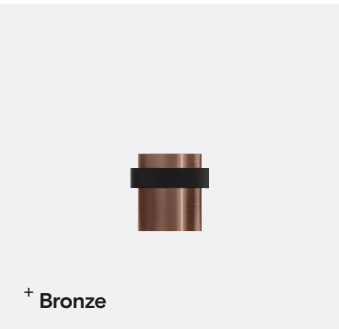
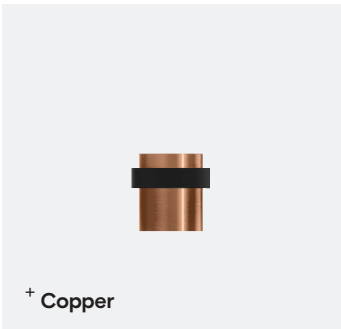
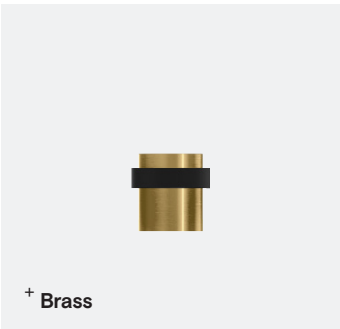
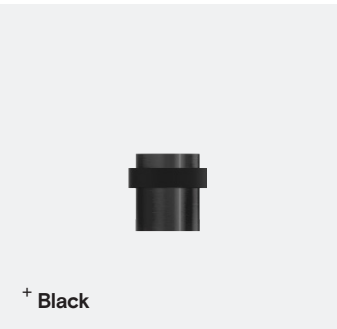
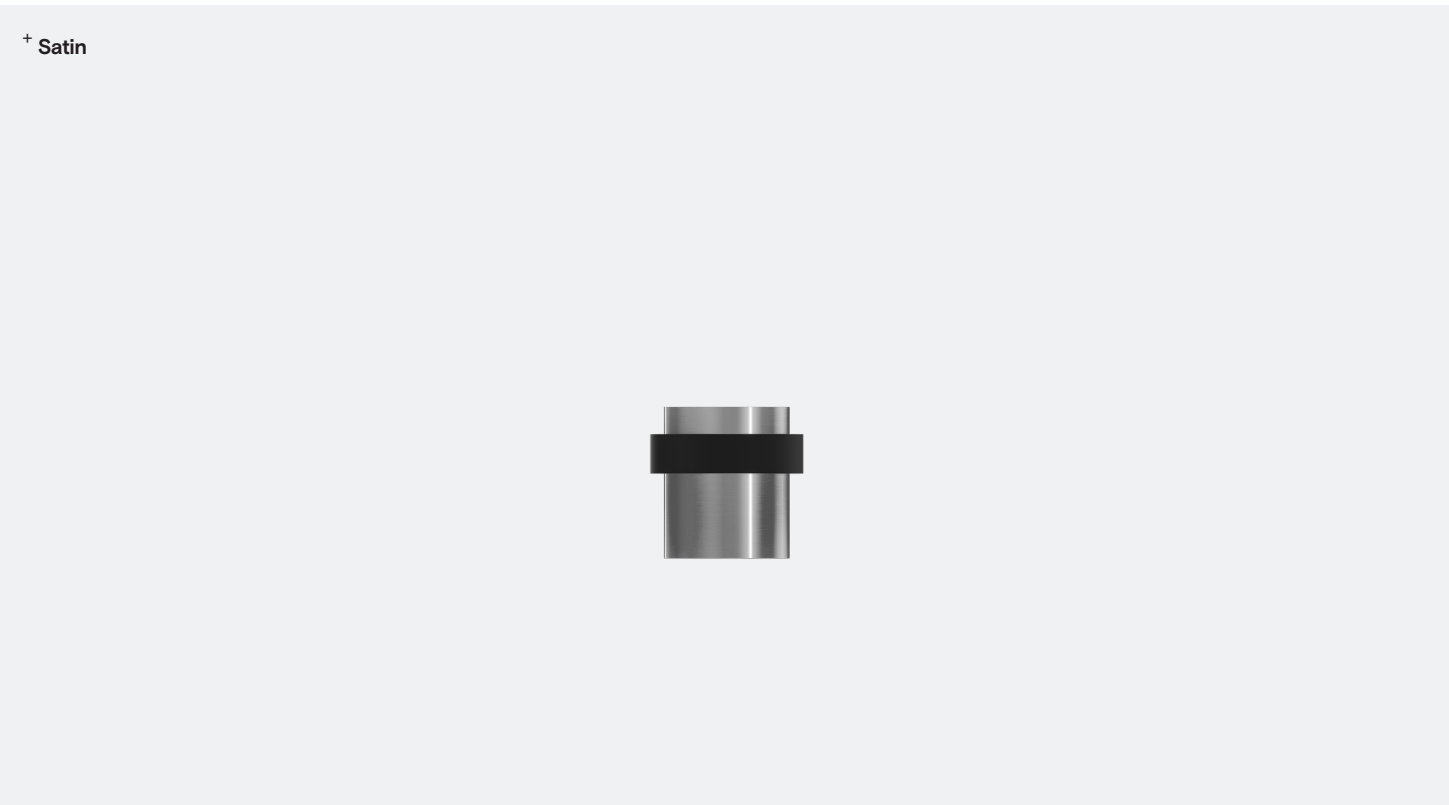

---

Floor Mounted Doorstop

---

1x No.8 wood screws

Material	Stainless steel
	Rubber
Steel grade	AISI316

1 year limited warranty

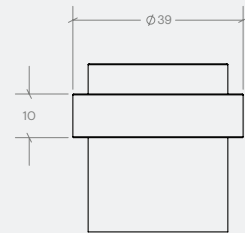
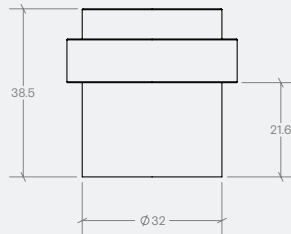
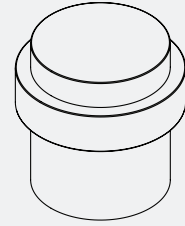

For warranty terms and conditions please visit [www.thesplashlab.com](http://www.thesplashlab.com)  
If additional spare parts are required and are not listed below, please contact us at [info.uk@thesplashlab.com](mailto:info.uk@thesplashlab.com)

Must be mounted to an appropriate hard surface  
The Splash Lab is not responsible for improper installation or misuse.

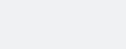

The image shows two views of a door handle. The left view is a side profile of a cylindrical handle with a horizontal grip. The right view is a top-down perspective of the same handle, showing a circular base with a small red indicator light and a horizontal slot for a key or tool.

REV 2025 27-May