

Stainless Steel Shelf / Large

TSL.12

The TSL.12 is a stainless steel shelf for personal items including colostomy bags. Suitable for all washrooms and compatible with Doc M/Doc T regulations. Offered in four PVD colours as well as brushed satin.

| Finish | Codes | LRV* |
|----------|-----------|------|
| ● Satin | TSL.12.CS | 58 |
| ● Black | TSL.12.BK | 3 |
| ● Brass | TSL.12.BR | 40 |
| ● Copper | TSL.12.CP | 19 |
| ● Bronze | TSL.12.BZ | 17 |

Light Reflectance Value*

+ Satin



+ Black



+ Brass



+ Copper



+ Bronze



Key Components/Spare Parts

Colostomy Shelf / Small
TSL.12

Technical Data

Stainless Steel AISI 304

+ Technical drawing

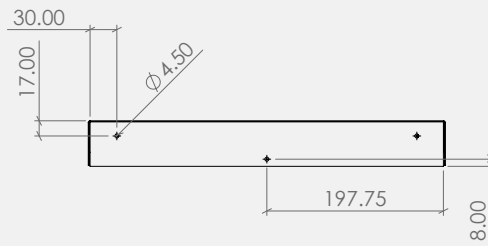
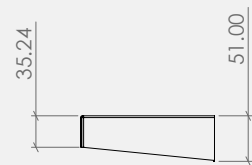
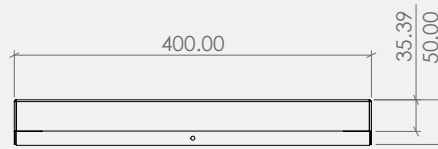
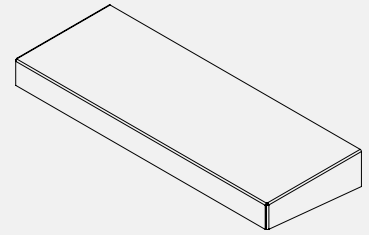
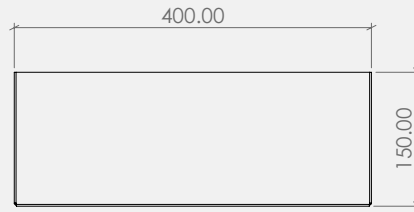

Warranty & Spare parts

For warranty terms and conditions please visit www.thesplashlab.com

If additional spare parts are required and are not listed above, please contact us at info.uk@thesplashlab.com

Related products



Stainless Steel Shelf / Small
TSL.11



Double Toilet Roll Holder
TSL.46



Coat Hook
TSL.974