





Deck Mounted Manual Tap

TSL.950

The TSL.950 is a deck-mounted manual tap that features a sleek spout, with an integrated lever operated mixer, available in a range of finishes.

Finish	Codes	LRV*
 Satin	TSL.950.CS	58
 Black	TSL.950.BK	3
 Brass	TSL.950.BR	40
 Copper	TSL.950.CP	19
 Bronze	TSL.950.BZ	17

*Light reflectance value

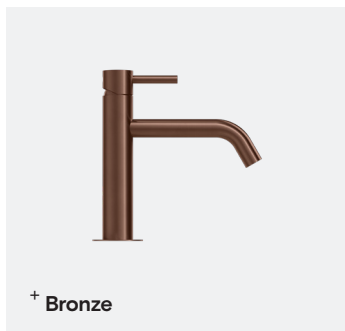
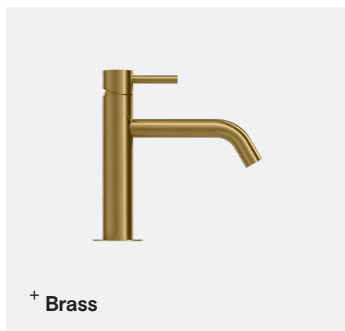
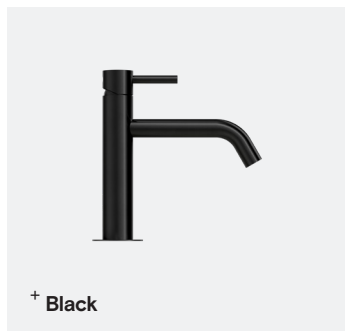

Technical Data

Body Material	AISI 304 Stainless Steel
Coating Type	PVD (colours only)
Aerator	Cascade
Water Pressure (Dynamic)	0.5 to 7.5 Bar [0.05 to 0.75MPa]
Water Temperature (Max)	60°C
Flow Rates	3.8 litres/minute - Cascade flow 1.9 litres / minute - Spray flow
Also available	1.35 litres / minute - Spray flow

Installation requirements

Countertop Cut-out size	Ø30mm
Maximum Countertop thickness	50mm
Water Supply	<p>0.5 Bar is the recommended minimum pressure for the taps to operate effectively. 7.5 Bar is the maximum pressure for commissioning and is NOT recommended for general use.</p> <p>Gravity-fed systems may require a booster pump to achieve the optimal operating pressure.</p> <p>All pipework must be thoroughly cleaned and clear of any debris before connecting the tap.</p>

Compliance certificates

BREEAM	Qualifies for up to 5 credits as part of water efficiency assessment
LEED	Water efficiency credits

BREEAM®



Included

Deck Mounted Manual Tap
TSL.950

+ Technical drawing

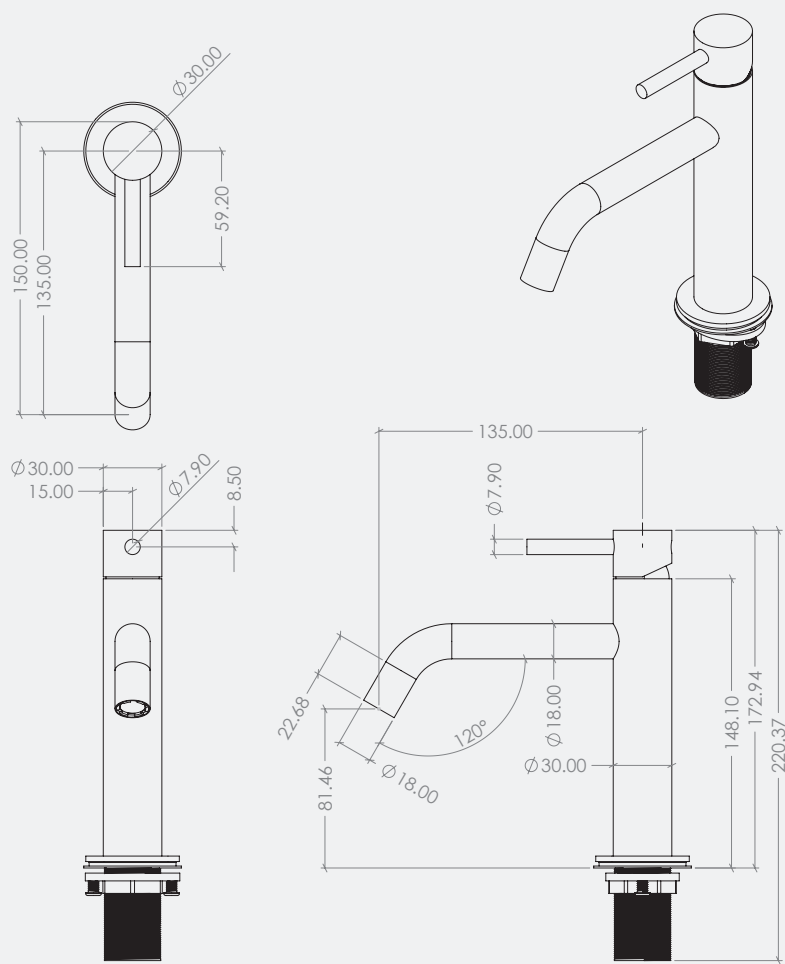

Warranty & Spare parts

For warranty terms and conditions please visit www.thesplashlab.com

If additional spare parts are required and are not listed below, please contact us at info.uk@thesplashlab.com

Related products



Straight Spout Tap Small
TSL.980

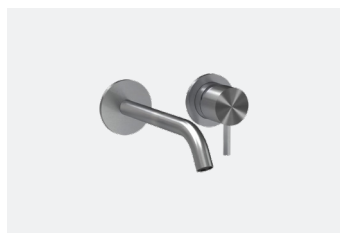

Wall-Mounted Manual Tap
TSL.970



Radius Auspex Tap 220mm
TSL.894