

# TSL.323

Toilet Brush with Holder

installation + maintenance

+  
THE  
SPLASH  
LAB

# contents

3	Box contents
4	Technical data
6	How to install
7	Operation + maintenance
8	Warranty
9	Contact

# box contents

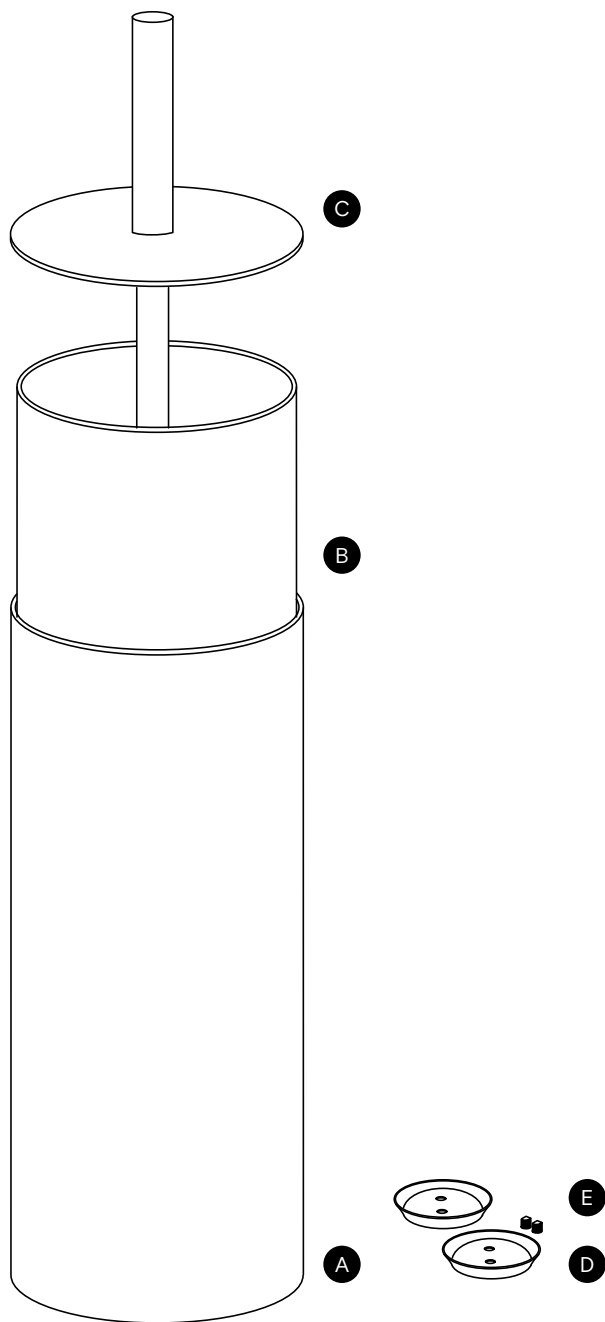

A Brush holder with wall mount

---

B Plastic liner

---

C Handle and brush assembly

---

D Mounting brackets x2

---

E Grub screws x2

---

\*product ships assembled

---

# technical data

CS (Brushed satin stainless steel)  
BK (PVD Black)  
BR (PVD Brass)  
CP (PVD Copper)  
BZ (PVD Bronze)

---

**Finishes**

---

**Weight**

1.5 kg

---

**Stainless steel grade**

304 AISI Stainless steel

---

**Warranty**

1 year limited warranty

---

**Installation requirements**

Use fixings suitable to the wall substrate

---

# technical illustration

## Location

The dispenser must be fitted in a cabinet (typically over a washbasin or washtub) with an opening (272 x 120mm) that will accommodate the hinged flaps at its base.

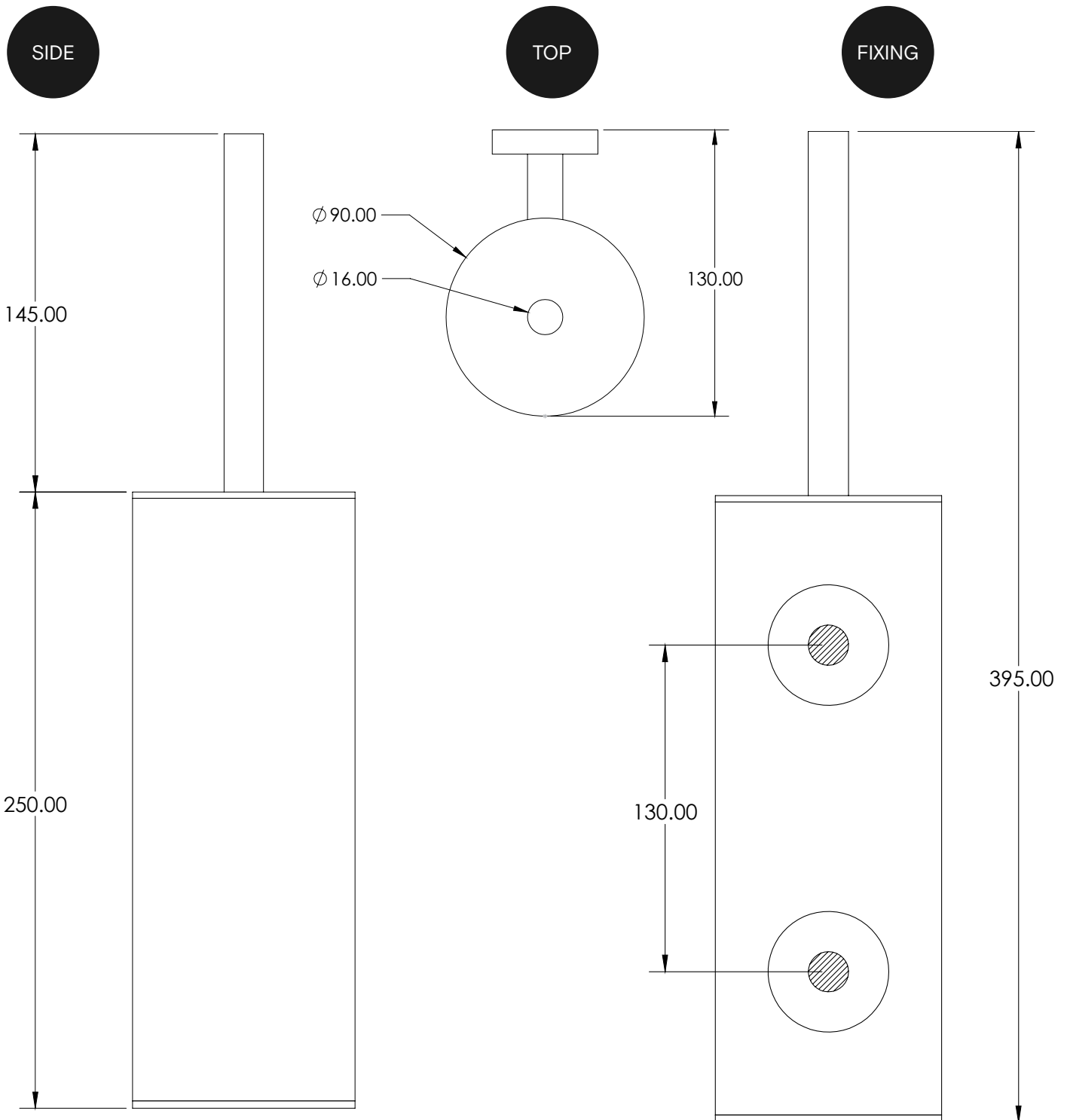

# mounting template

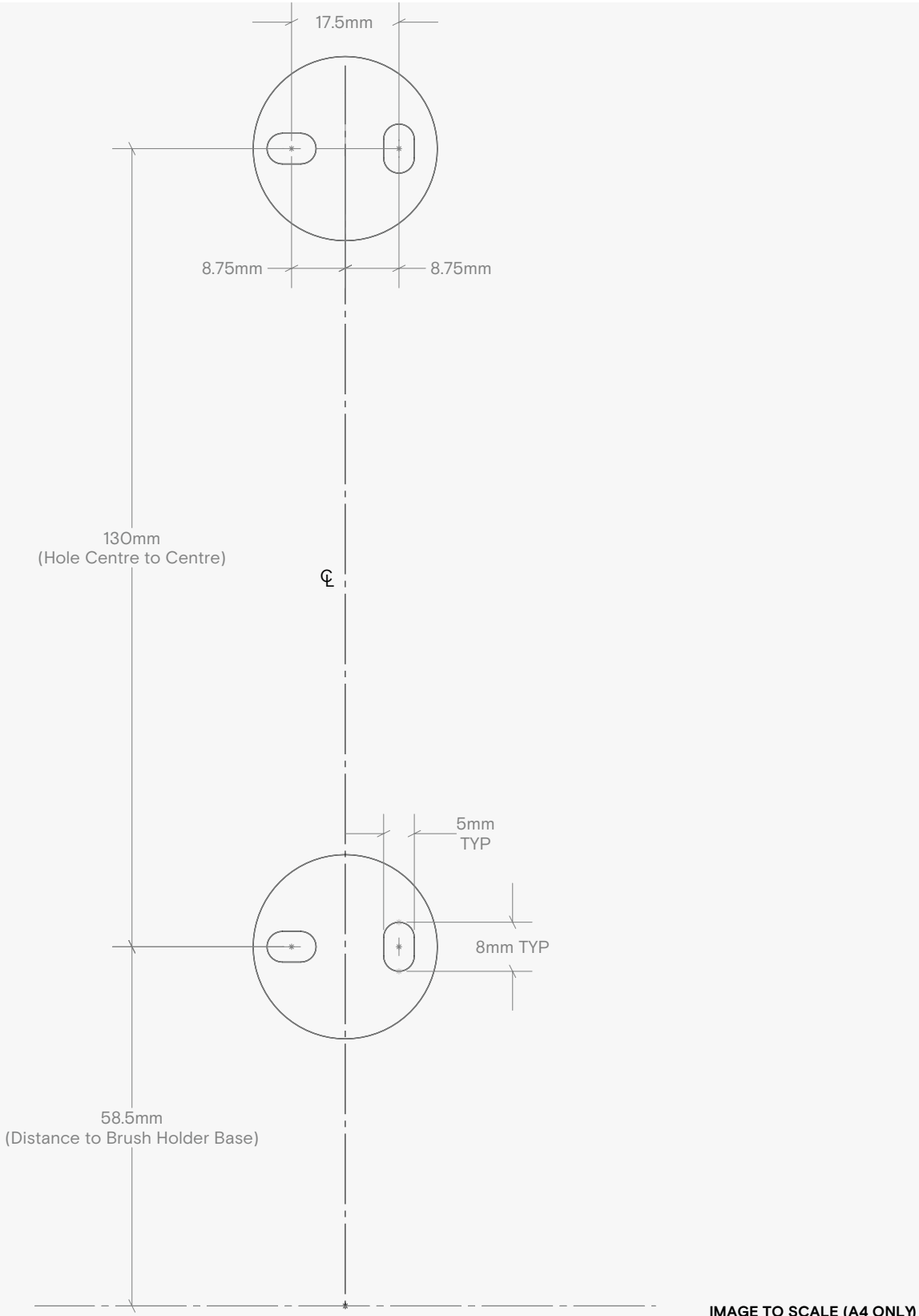

# operation + maintenance

## operation

Remove the brush from the housing and use as needed.

## cleaning

All grades of stainless steel will stain or discolour if due care and attention is not taken. The surface must be regularly cleaned to ensure a long service life of the dispenser.

Use a soft cloth or sponge with a mild solution of soapy water as part of the regular washroom janitorial routine.

Do not use abrasive or cream cleaners as these will damage the surface finish.

If the dispenser is subjected to a highly chlorinated environment eg swimming pools or marine coastal locations, a further treatment, in addition to the regular cleaning as described above, is recommended by the application of a household cleaning product containing silicone.

If further information is required, contact The Splash Lab's technical team for more detailed stainless-steel care guidelines.

The plastic liner can be removed for cleaning with a gentle antibacterial cleanser.

## maintenance

The dispenser should be inspected periodically to check that no damage has occurred.

# warranty

We believe the future is personal. With a global mindset, we challenge conventional restroom norms via product innovation to create considered washroom solutions for corporate and educational spaces. We use rich raw materials, cutting-edge automation and considered washroom design to powerfully and positively influence the lives of people. We are The Splash Lab.

Demonstrating our commitment to quality and our belief in the strength of our designs, we can offer the following warranties.

The Splash Lab will warrant that its products will be free of manufacturing and material defects during normal use and environmental conditions as detailed below:

## **TSL.323 Toilet Brush with Holder      1 year limited warranty**

If a defect is found in normal use, The Splash Lab will, at their discretion, repair, provide a replacement part or product, or make appropriate adjustments. Damage caused by accident, misuse, or abuse is not covered by this warranty. Improper care and cleaning will void the warranty.

Non-operation of the product due to environmental conditions beyond our control, installation error, incorrect maintenance, water quality, fair wear and tear, incorrect or inappropriate installation, misuse and abuse is not covered by the warranty.

Proof of purchase (original sales receipt) must be provided to The Splash Lab with all warranty claims. The above warranty is valid for goods supplied within the United Kingdom.

For goods supplied outside of the United Kingdom, The Splash Lab will honor the above stated warranty periods for the parts only.

**THE SPLASH LAB DISCLAIMS ANY LIABILITY FOR SPECIAL, INCIDENTAL OR CONSEQUENTIAL DAMAGES.**



# contact



## General information

[info.uk@thesplashlab.com](mailto:info.uk@thesplashlab.com)

+44 (0)161 482 7000

Unit 34, Meadow Industrial Estate,

Water Street

Stockport SK1 2BU

United Kingdom

Technical support

[info.uk@thesplashlab.com](mailto:info.uk@thesplashlab.com)

For further information visit:

[www.thesplashlab.com/uk](http://www.thesplashlab.com/uk)

