

L-460

Panel Mounted Sensor Operated Soap
Dispenser

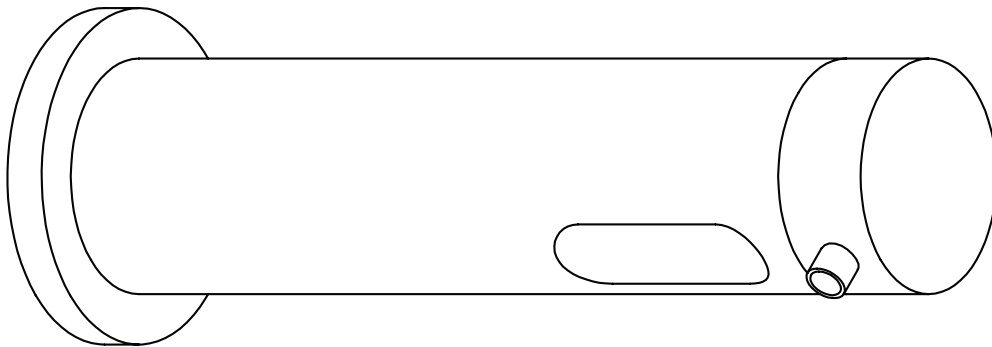

installation + maintenance

+
THE
SPLASH
LAB

contents

3	Box contents
4	Technical data L-460C
6	Technical data L-460CS
8	Before you install
9	How to install
12	Filling the soap
13	Setting adjustment with a remote control
14	Operation + maintenance
15	Troubleshooting
16	Warranty
17	Contact us

box contents

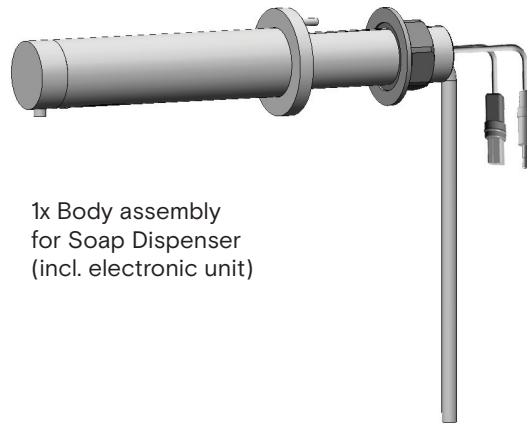

1x Body assembly
for Soap Dispenser
(incl. electronic unit)

■ 1 x M 4 x 4 Set Screw

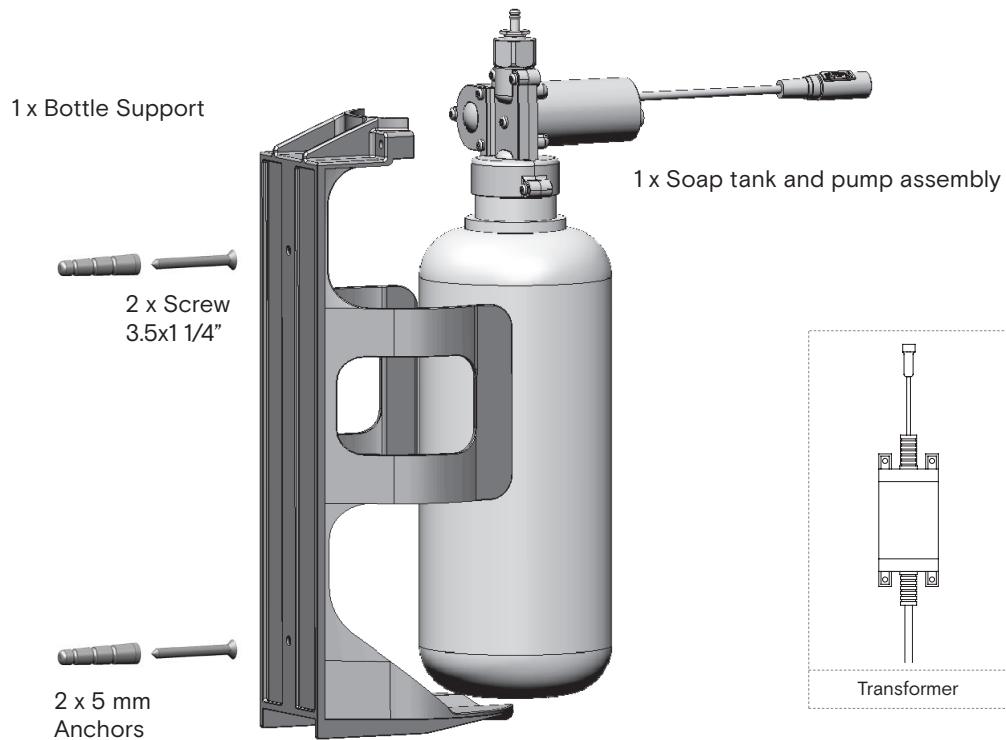

1 x Bottle Support

2 x Screw
3.5x1 1/4"

2 x 5 mm
Anchors

1 x Soap tank and pump assembly

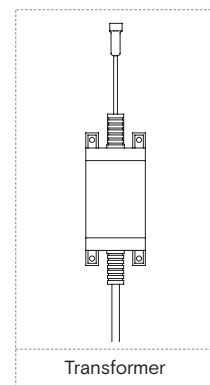

Transformer

technical data

L-460C

Finishes	C (Chrome)
Weight	0.86Kg
Recommended soap viscosity	100-3800cPs For liquid soap only. Not for use with foam soap, alcohol gel or hand sanitizer.
Standard discharge	0.8cc adjustable
Body brass	Chrome plated
Soap system	1 litre soap bottle and pump
Power supply unit (PSU)	(IP68 rated 12V transformer with push-fit cabling to dispenser)
Warranty	1 years limited warranty

technical data

L-460C

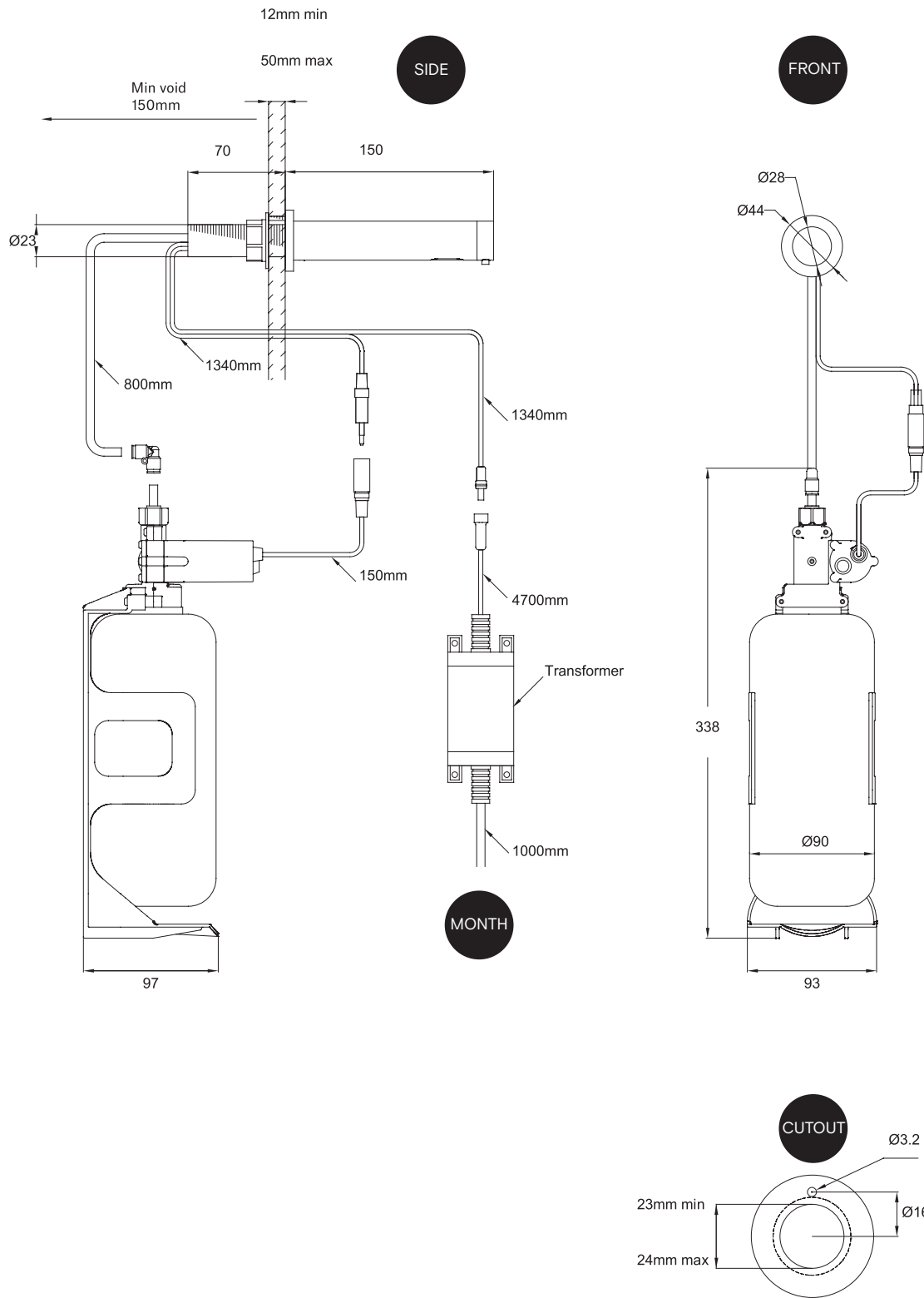

technical data

L-460CS

Finishes	CS Brushed Satin Finish
Weight	0.86Kg
Recommended soap viscosity	100-3800cPs For liquid soap only. Not for use with foam soap, alcohol gel or hand sanitizer.
Standard discharge	0.8cc adjustable
Body brass	AISI 316 Stainless Steel
Soap system	1 litre soap bottle and pump
Power supply unit (PSU)	Mains power (IP68 rated 12V transformer with push-fit cabling to dispenser)
Warranty	1 years limited warranty

technical data

L-460CS

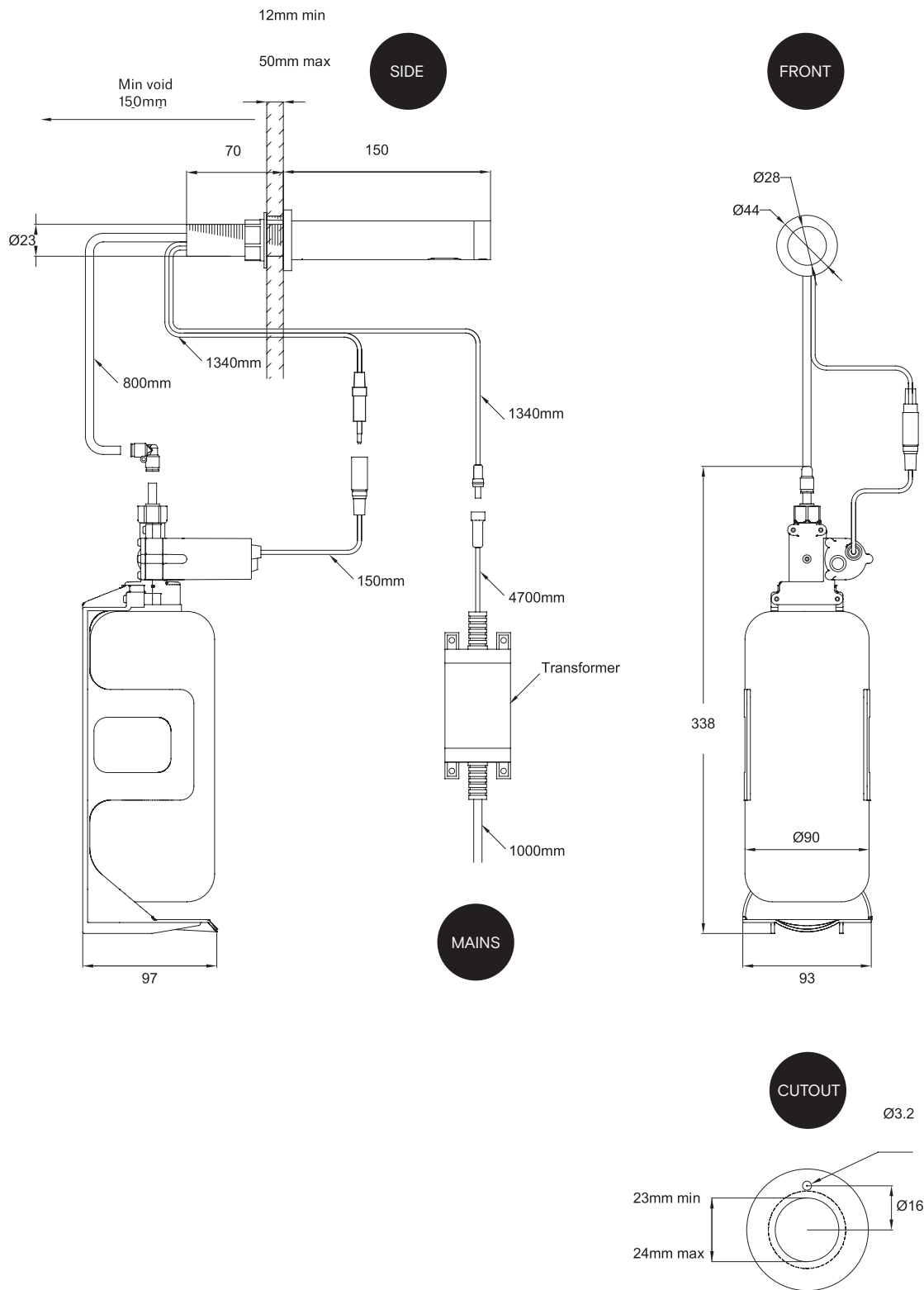

before you install

Check contents

Separate all parts from the packaging and check each part with the “Pack contents” section. Make sure all parts are accounted for before discarding any packaging material.

If any parts are missing, do not attempt to install your touch free soap dispenser until you obtain the missing parts.

Important

All plumbing is to be installed in accordance with applicable codes and regulations.

Warnings

1. To avoid reflection problems keep a distance of more than 300 mm. between the sink and the spout.
2. This dispenser must be installed 150mm (6”) away from other fixtures.
3. The sink countertop ledge can protrude no more than 50mm (2”) from the back wall.

Important: Keep in mind that the location of the user hands, while using the faucet nearby should not interfere with the soap dispenser sensor detection area.

how to install

Check contents

Separate all parts from the packaging and check each part with the “Pack contents” section. Make sure all parts are accounted for before discarding any packaging material.

If any parts are missing, do not attempt to install your touch free soap dispenser until you obtain the missing parts.

Important

All plumbing is to be installed in accordance with applicable codes and regulations.

Warnings

1. To avoid reflection problems keep a distance of more than 300 mm. between the sink and the spout.
2. This dispenser must be installed 150mm (6”) away from other fixtures.
3. The sink countertop ledge can protrude no more than 50mm (2”) from the back wall.

Important: Keep in mind that the location of the user hands, while using the faucet nearby should not interfere with the soap dispenser sensor detection area.

how to install

Step 1 – Preparing for installation

1. Drill a hole (23 to 24 mm) at the desired location for the soap dispenser spout installation.
2. Drill a small hole (3.2 mm) just above the previous one for the anti-rotation pin, according to the diagram.
3. Remove the hexagonal nut and the disk from the base of the soap dispenser spout.

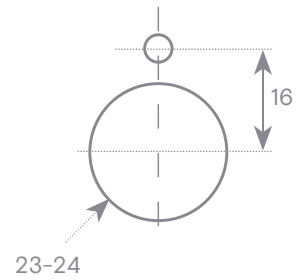

Step 2 – Installing the soap dispenser

1. Insert the Soap dispenser base.
2. Insert the anti-rotation pin into the small hole.
3. Fix the base behind the wall with the hexagonal nut and the disk.

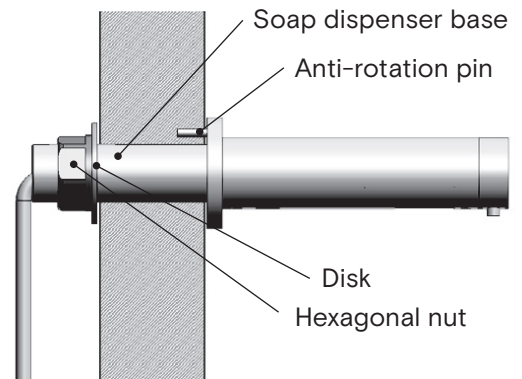

4. Fix the bottle support to the desired location.

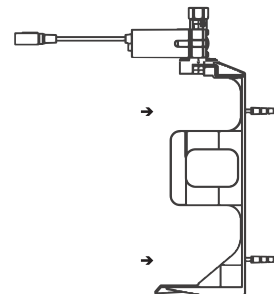

5. Assemble the tube from the pump to the soap dispenser.

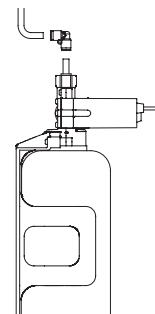

how to install

Step 3 - Connecting the power source

1. Remove the protective sticker covering the sensor.
Keep away from the sensor range and check that no objects are in front of the sensor.



2. a. Connect the motor connector to the power source connector. Please note that since the connector is water proof, some friction might apply.

Important: the 4 contacts connector should be connected properly so that the white o-ring is not visible and a clicking sound is heard.

Attention: If the 4 contact-connectors are not connected properly, the motor will work continuously.

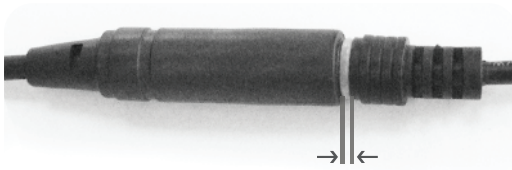

O-ring visible - not connected properly



↑
Connected properly so that only the grooves are visible

- b. Connect transformer into the electricity supply and connect the transformer connector

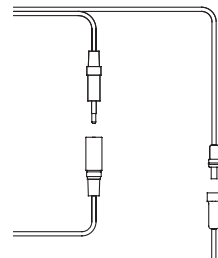

3. Wait about 10 seconds before you put your hands within the sensor range.



filling the soap tank

1. Unscrew the soap tank from the pump assembly.

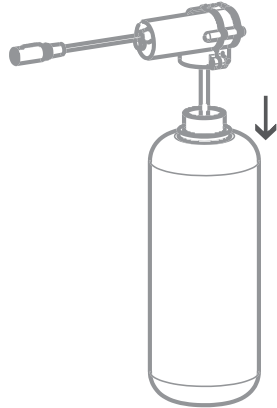

2. Fill in the liquid soap up to the top line.

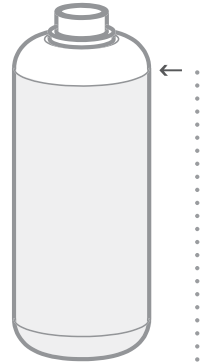

3. Insert the bottle with the tube inside the bottle support.

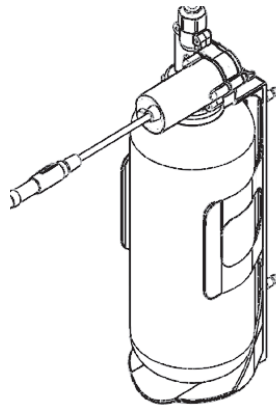

4. Screw the soap tank back to the pump assembly. Make sure the tank is secured firmly in place.

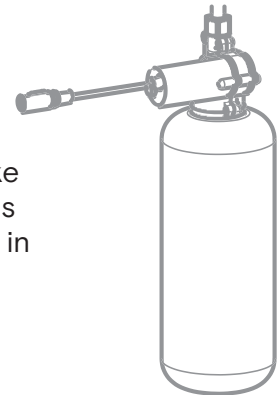

5. Press the refill button located at the back of the pump assembly until soap starts coming out of the soap dispenser spout. This operation can also be done using the soap dispenser remote control Refill function.

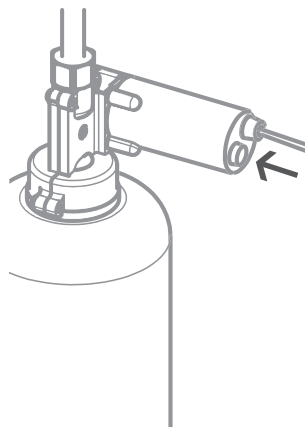

Note: Once the soap in the soap tank has reached the bottom line the soap tank should be refilled. To refill the soap tank please refer to steps 1-5.

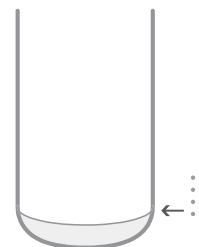

settings adjustment with a remote control

If desired, use the remote control to adjust the soap dispenser settings.

Hold the remote control straight in front of the sensor in a distance of about 4-6" (10-15cm).

Attention: Holding the soap dispenser remote control out of the recommended range (too close or too far) may interfere with the remote's activation.

Choose the function you want to adjust by pressing on the function button as following:

1. Soap volume

The 1-4 drop keys allow the user to choose the desired soap quantity.

- a. 0.2 – 0.4ml
- b. 0.7 – 0.9ml
- c. 1.2 – 1.6ml
- d. 2.1 – 2.3ml

Indication: continues blink of the red light in the sensor eye.

* The exact soap dosage depends on the soap viscosity.



2. ADJ

This function allows coming back to soap quantity factory settings. Press the ADJ button.

Indication: 2 blinks of the red light in the sensor eye.

3. Temporary off function

This function is ideal to perform any kind of activity in front of the sensor without operating the system (for example, cleaning). The soap dispenser will remain shut for 1 minute when this button is pressed once. To cancel this function and to return to no

Indication: OFF – 2 fast blinks, ON – 4 fast blinks

4. Refill the soap tank

Once the soap tank has been refilled, press the FILL button. The pump would work for one minute in order for the soap to start coming out of the soap dispenser spout. To stop this activity press the FILL button again.

operation + maintenance

cleaning

The dispenser should be cleaned with a soft cloth and a mild solution of soapy water as part of the regular cleaning regime. Do not use abrasive or cream cleaners, as these will damage the surface finish.

maintenance

The dispenser should be activated at least daily to ensure that soap does not congeal in the pipework. If soap does become solidified, the dispenser and pipework should be flushed with warm water until the soap has been cleared

refilling

A good quality liquid soap of viscosity 100 – 3800 cPs units should be used. Hand cleaners containing abrasive particles should not be used as this will cause damage to the pump mechanism.

The Splash Lab recommend the range of hand soaps available from Selden Research. Visit www.selden.co.uk for further details.

spare parts

For warranty terms and conditions please visit www.thesplashlab.com/uk

If additional spare parts are required and are not listed above, please contact us at info.uk@thesplashlab.com

troubleshooting

Problem	Indicator	Cause	Solution
No soap coming out of the spout	Red light in the sensor flashes continuously when the user's hands are within the sensor's range.	Low battery	Replace battery
	Red light in the sensor flashes (once) and the motor is operating.	Soap has run low or completely out.	Refer to page 8 and refill the soap tank.
		The soap tank has been filled but soap has not reached the spout.	Press the refill button located at the bottom of the pump until soap starts to come out of the spout again.
		The connectors between the motor and the power source are not connected properly.	Connect the connectors all the way through. Refer to page 7 to see how.
	Red light in the sensor does not flash (once) when user's hands are within the sensor's range.	Sensor is picking up reflections from the washbasin or another object.	Eliminate cause of reflection.
		Connectors between the electronic unit and the pump assembly \ transformer are disconnected or not properly connected.	Connect the electronic unit connectors to the pump assembly and transformer.
		Battery is completely used up.	The battery must be replaced.
	Red light flashes (once) and the motor operates.	Soap solidification at the pipe.	Fill the bottle with hot water at 50/60C and run the pump constantly.
Soap coming out from the spout does not stop		The black connector between the pump assembly and soap dispenser are not connected all the way through.	Connect the black connectors all the way through.

warranty

We believe the future is personal. With a global mindset, we challenge conventional restroom norms via product innovation to create considered washroom solutions for corporate and educational spaces. We use rich raw materials, cutting-edge automation and considered washroom design to powerfully and positively influence the lives of people. We are The Splash Lab.

Demonstrating our commitment to quality and our belief in the strength of our designs, we can offer the following warranties.

The Splash Lab will warrant that its products will be free of manufacturing and material defects during normal use and environmental conditions as detailed below:

Sensor-operated soap dispenser 1 year limited warranty

If a defect is found in normal use, The Splash Lab will, at their discretion, repair, provide a replacement part or product, or make appropriate adjustments. Damage caused by accident, misuse, or abuse is not covered by this warranty. Improper care and cleaning will void the warranty.

Non-operation of the product due to environmental conditions beyond our control, installation error, incorrect maintenance, water quality, fair wear and tear, incorrect or inappropriate installation, misuse and abuse is not covered by the warranty.

Proof of purchase (original sales receipt) must be provided to The Splash Lab with all warranty claims. The above warranty is valid for goods supplied within the United Kingdom.

For goods supplied outside of the United Kingdom, The Splash Lab will honor the above stated warranty periods for the parts only.

THE SPLASH LAB DISCLAIMS ANY LIABILITY FOR SPECIAL, INCIDENTAL OR CONSEQUENTIAL DAMAGES.

contact



General information

info.uk@thesplashlab.com

+44 (0)161 482 7000

Unit 34, Meadow Industrial Estate,

Water Street

Stockport SK1 2BU

United Kingdom

Technical support

info.uk@thesplashlab.com

For further information visit:

www.thesplashlab.com/uk

